



Feramolli
arte dell'acqua

Feramolli Rubinetterie Srl
Via L. Abbiati,
48 - 25131 - Brescia (BS) Italy
+39 800 940 525
global@feramolli.com
www.feramolli.com

Please note:

Feramolli Rubinetterie reserves the right to modify specifications shown, or delete products, from their range without prior notification.

SOLE series



Feramolli
arte dell'acqua



About Feramolli

THE HIGHEST QUALITY STANDARDS AND A UNIQUE STYLE OF PRODUCTS ARE TWO MAIN OBJECTIVES FOR US.

Striving for the ideal in everything is the strategic goal of Feramolli. To achieve it, the brand constantly invests enormous resources to implement the latest technical developments and design ideas. The art of water in all its manifestations, the perfection of forms and lines, the virgin nature of Italian rivers and lakes, are a great inspiration for the company's designers, who every day draw new ideas for the development of a unique design of Feramolli products.

We are dedicated to creating stylish and high-quality bathroom wares that stand the test of time. Our commitment to excellence is reflected in every aspect of our business, from our stringent quality control measures to our innovative designs.

Quality is at the heart of everything we do. We use only the finest materials and the latest manufacturing techniques to ensure that every product we create is of the highest quality.

Innovation is key to our success. We're constantly pushing the boundaries of what's possible in bathroom design, creating products that are not only visually stunning but also practical and user-friendly. And provide up to 9 different stunning colours for choice.

Sustainability is a core value of our brand. We are committed to reducing our environmental impact and creating products that are eco-friendly and sustainable. We're always looking for ways to make a positive difference.

Service is our top priority. Our professional and friendly customer service team committed to providing you with the best possible experience.

We believe that a beautiful bathroom is essential to a happy and healthy life. That's why we are passionate about creating products that not only look great but also stand up to the rigours of everyday use. We invite you to explore our range and discover the perfect products for your bathroom today.



The brand new SOLE series by Feramolli is based on this design concept
SOLE's multi-faceted texture design has diamond prisms with multiple angles.
The structure of each element resembles a pyramidal structure reflecting the
color of the sun.

The multiple facets, create light reflections,
that will add endless visual experience to your bathroom space.
Every face is beautiful and every detail is meticulously crafted.



Innovative design of The SOLE series

Hundreds of small crystals reflect the light and give your bathroom an incomparable unique shine.

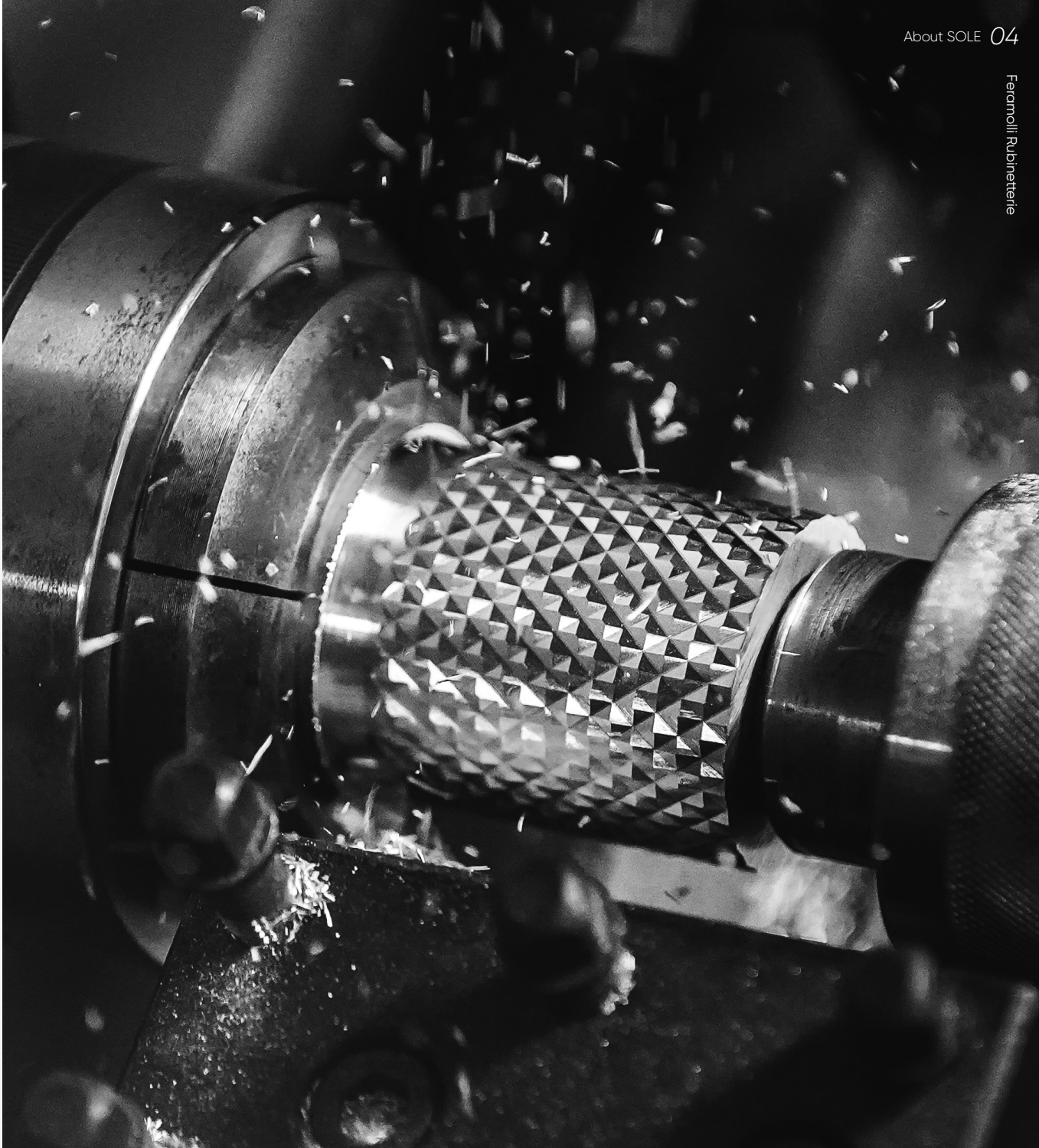

Innovative Carving Technology

Making Your Bathroom Ultra Stylish. Innovative cutting technology makes every piece shimmer as it catches the light. The result is sophisticated and dazzling. All products are made to last, using only the highest quality materials and craftsmanship. We construct them using DZR Brass.

Brushed Nickel

Brushed Gold

Brushed Graphite

Brushed Copper

Colorful Unpredictable

4 colour options.
Perfect meets the style requirements of todays bathrooms.
Resulting in pure artistry.

MIXER TAPS

- Brushed Nickel
- Brushed Copper
- Brushed Gold
- Brushed Graphite



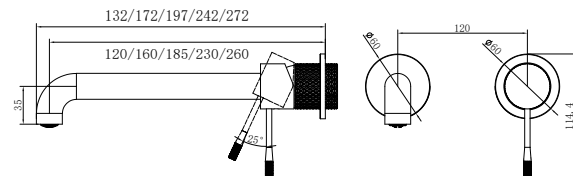
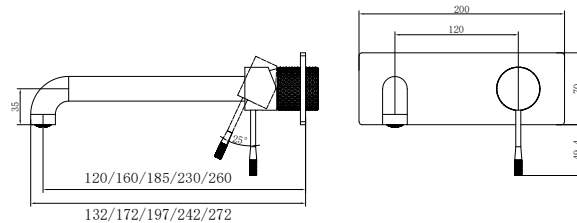
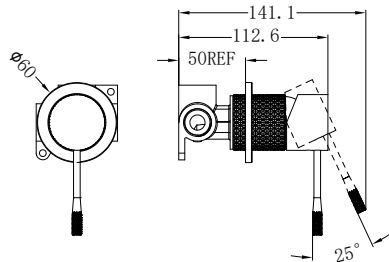
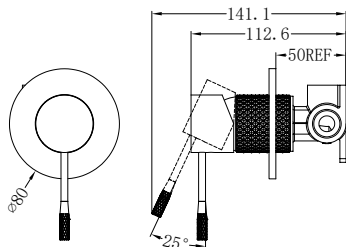
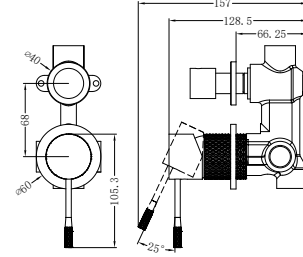
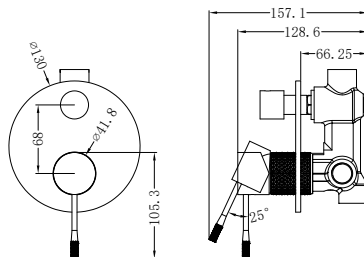
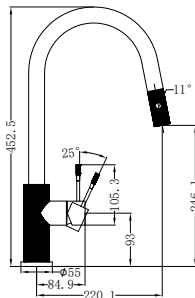
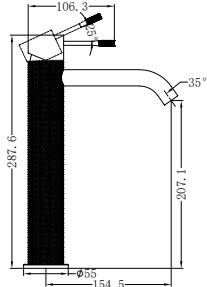
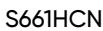



S661GL

SOLE Basin Mixer
Water Consumption: 5 Star, 5L/Min
Brushed Gold

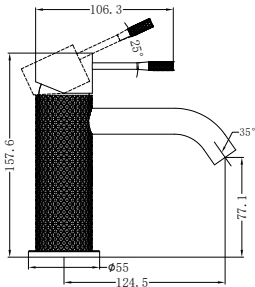
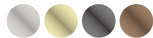

S615GL

SOLE Shower Mixer With 80mm Plate
Water Consumption: N/A
Brushed Gold

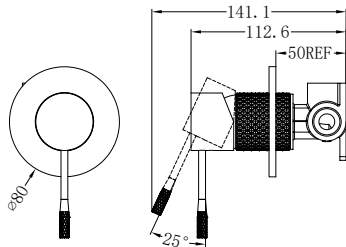
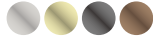

S661HGL

SOLE Tall Basin Mixer
Water Consumption: 5 Star, 5L/Min
Brushed Gold

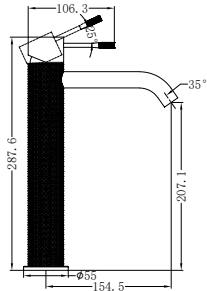
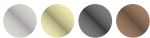

S614GL

SOLE Shower Mixer With 60mm Plate
Water Consumption: N/A
Brushed Gold

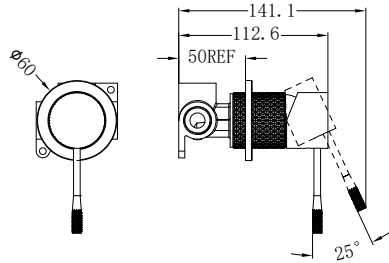
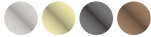

S517GL

SOLE Pull Out Sink Mixer With
Veggie Spray Function
Water Consumption: 6 Star, 4.5L/Min
Brushed Gold

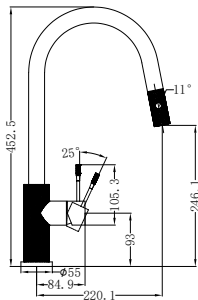
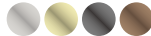



S619GL

SOLE Shower Mixer With Divertor
Water Consumption: N/A
Brushed Gold

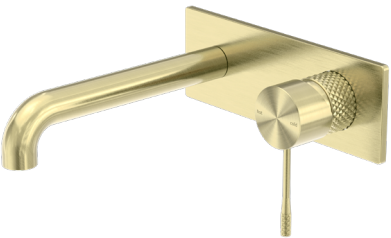
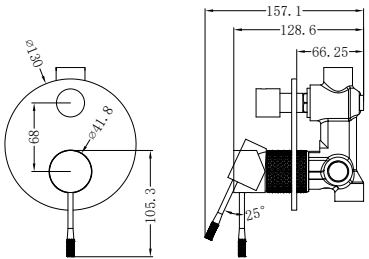
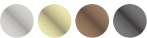

S668-13GL/S668-17GL
S668-20GL/S668-24GL/S668-27GL

SOLE Wall Basin/Bath Mixer 120/160/185/230/260mm Spout
Water Consumption: 5 Star, 6L/Min
Brushed Gold

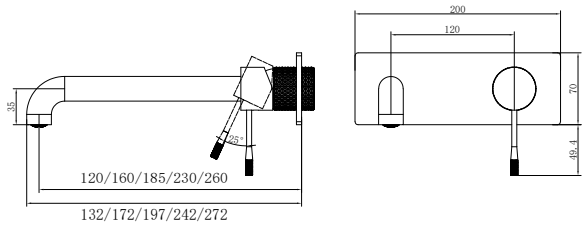

S618GL

SOLE Shower Mixer With Divertor Separate Plate
Water Consumption: N/A
Brushed Gold

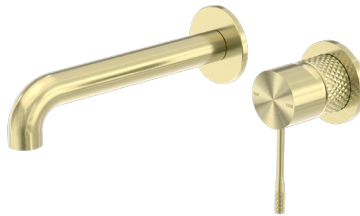
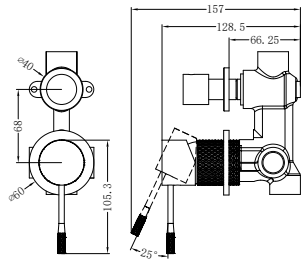
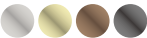

S667-13GL/S667-17GL
S667-20GL/S667-24GL/S667-27GL

SOLE Wall Basin/Bath Mixer 120/160/185/230/260mm
Spout Separate Back Plate
Water Consumption: 5 Star, 6L/Min
Brushed Gold

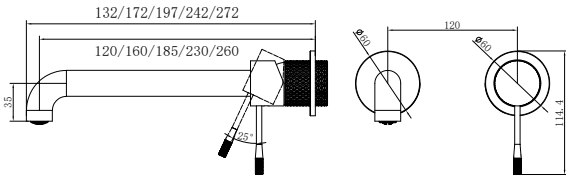



S661BB

SOLE Basin Mixer
Water Consumption: 5 Star, 5L/Min
Brushed Copper

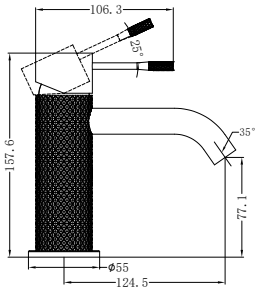
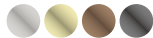

S661HBB

SOLE Tall Basin Mixer
Water Consumption: 5 Star, 5L/Min
Brushed Copper

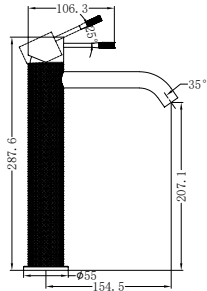
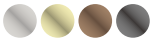

S517BB

SOLE Pull Out Sink Mixer With
Vegie Spray Function
Water Consumption: 6 Star, 4.5L/Min
Brushed Copper

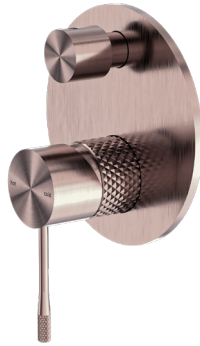
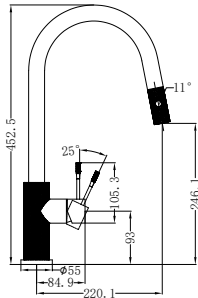

S619BB

SOLE Shower Mixer With Divertor
Water Consumption: N/A
Brushed Copper

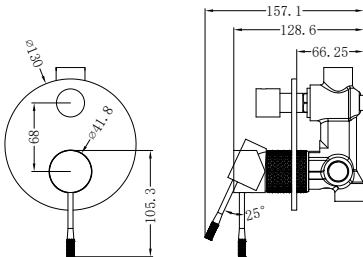

S618BB

SOLE Shower Mixer With Divertor Separate Plate
Water Consumption: N/A
Brushed Copper

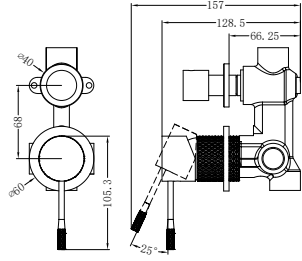
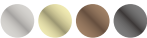

S615BB

SOLE Shower Mixer With 80mm Plate
Water Consumption: N/A
Brushed Copper

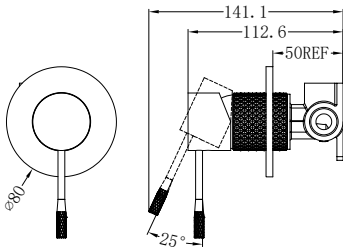

S614BB

SOLE Shower Mixer With 60mm Plate
Water Consumption: N/A
Brushed Copper

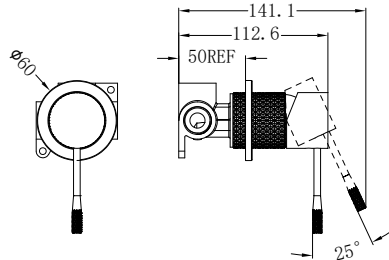

S668-13BB/S668-17BB
S668-20BB/S668-24BB/S668-27BB

SOLE Wall Basin/Bath Mixer 120/160/185/230/260mm Spout
Water Consumption: 5 Star, 6L/Min
Brushed Copper

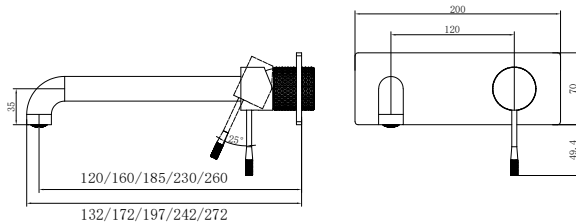

S667-13BB/S667-17BB
S667-20BB/S667-24BB/S667-27BB

SOLE Wall Basin/Bath Mixer 120/160/185/230/260mm Spout
Separate Back Plate
Water Consumption: 5 Star, 6L/Min
Brushed Copper

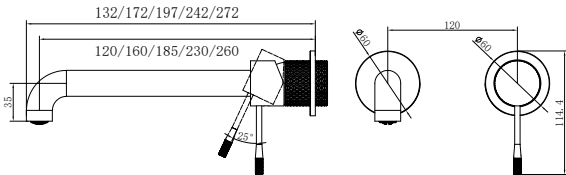



S661GB

SOLE Basin Mixer
Water Consumption: 5 Star, 5L/Min
Brushed Graphite

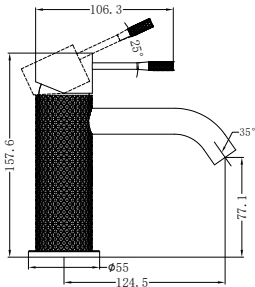
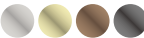

S661HGB

SOLE Tall Basin Mixer
Water Consumption: 5 Star, 5L/Min
Brushed Graphite

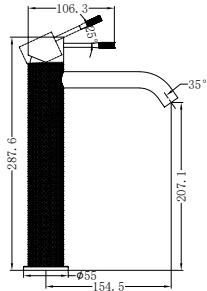
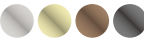

S517GB

SOLE Pull Out Sink Mixer With
Vegie Spray Function
Water Consumption: 6 Star, 4.5L/Min
Brushed Graphite

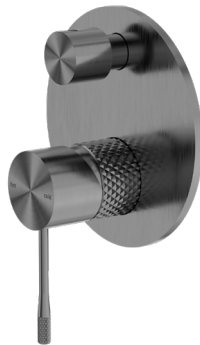
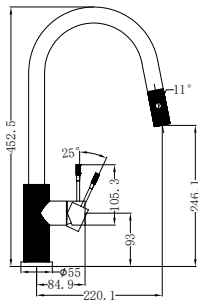

S619GB

SOLE Shower Mixer With Divertor
Water Consumption: N/A
Brushed Graphite

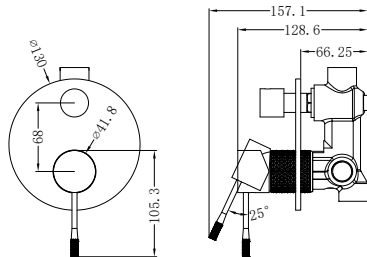
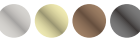

S618GB

SOLE Shower Mixer With Divertor Separate Plate
Water Consumption: N/A
Brushed Graphite

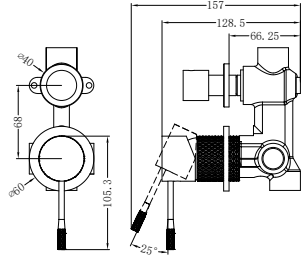
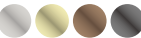

S615GB

SOLE Shower Mixer With 80mm Plate
Water Consumption: N/A
Brushed Graphite

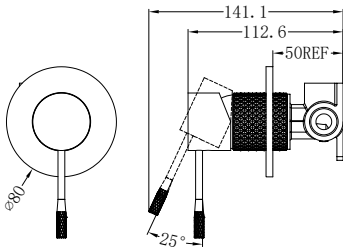

S614GB

SOLE Shower Mixer With 60mm Plate
Water Consumption: N/A
Brushed Graphite

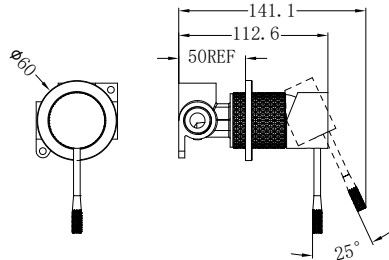

S668-13GB/S668-17GB
S668-20GB/S668-24GB/S668-27GB

SOLE Wall Basin/Bath Mixer 120/160/185/230/260mm Spout
Water Consumption: 5 Star, 6L/Min
Brushed Graphite

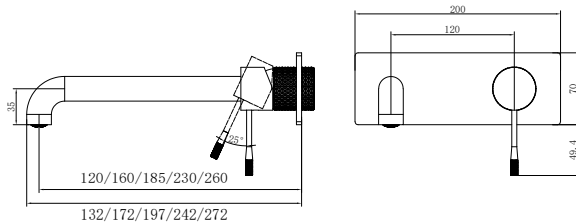

S667-13GB/S667-17GB
S1907GLR/S667-24GB/S667-27GB

SOLE Wall Basin/Bath Mixer 120/160/185/230/260mm Spout
Separate Back Plate
Water Consumption: 5 Star, 6L/Min
Brushed Graphite

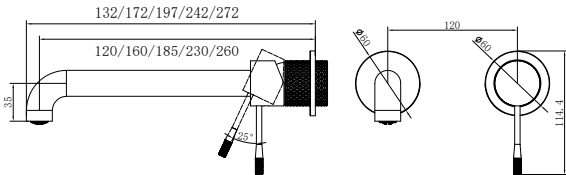

SOLE Progressive

- Brushed Nickel
- Brushed Copper
- Brushed Gold
- Brushed Graphite





S651CN

SOLE Progressive Basin Set
Water Consumption: 6 Star, 4.5L/Min
Brushed Nickel

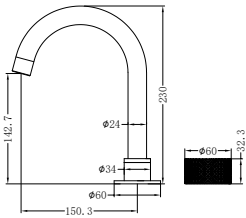
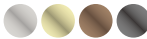

S652CN

SOLE Progressive Tall Basin Set
Water Consumption: 5 Star, 6L/Min
Brushed Nickel

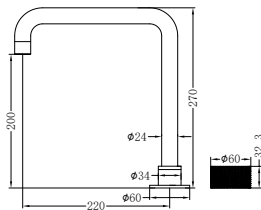

S669-13CN/S669-17CN S669-20CN/
S669-24CN/S669-27CN

SOLE Progressive Wall Basin/Bath Set 120mm
/160mm/185mm/230mm/260mm Spout
Water Consumption: 5 Star, 6L/Min
Brushed Nickel

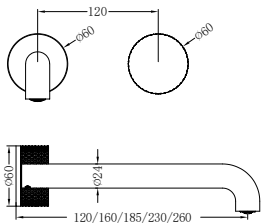
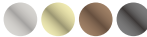

S519CN

SOLE Progressive Pull Out Kitchen Set
Water Consumption: 6 Star, 4.5L/Min
Brushed Nickel

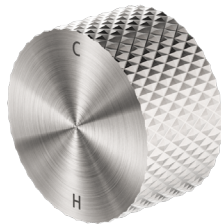
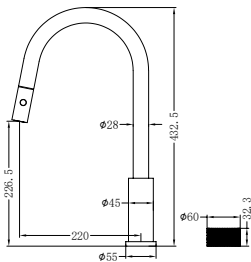
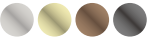

S605CN

SOLE Progressive Shower Mixer
Water Consumption: N/A
Brushed Nickel

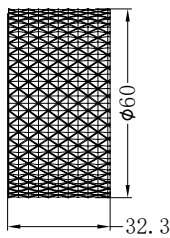
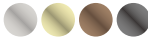

S251-23CN

SOLE Progressive Bath and Shower System
With Spout 230mm
Water Consumption: 7.5L/Min
Brushed Nickel

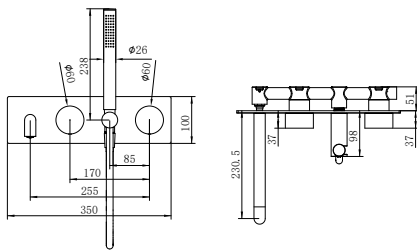
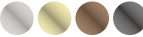

S251-25CN

SOLE Progressive Bath and Shower System
With Spout 250mm
Water Consumption: 7.5L/Min
Brushed Nickel

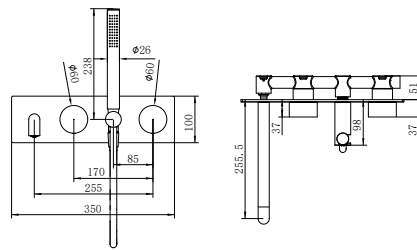

S250-23CN

SOLE Progressive Bath and Shower System
Separate Plate With Spout 230mm
Water Consumption: 7.5L/Min
Brushed Nickel

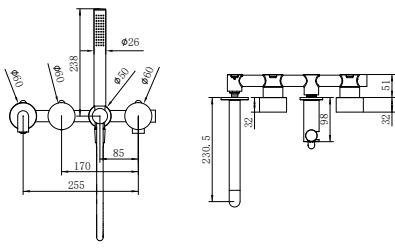
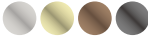

S250-25CN

SOLE Progressive Bath and Shower System
Separate Plate With Spout 250mm
Water Consumption: 7.5L/Min
Brushed Nickel

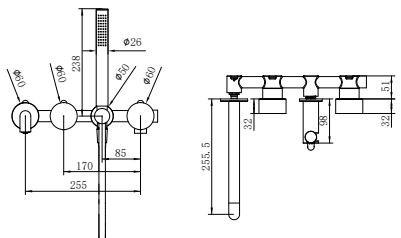

S681CN

SOLE Progressive Shower System
Water Consumption: 7.5L/Min
Brushed Nickel

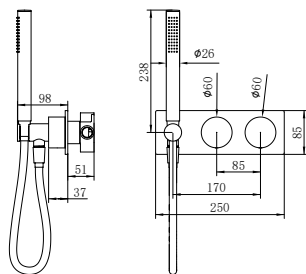
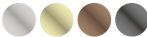

S680CN

SOLE Progressive Shower System
Separate Plate
Water Consumption: 7.5L/Min
Brushed Nickel

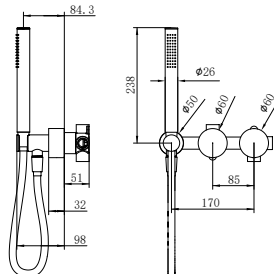
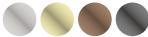



S651GL

SOLE Progressive Basin Set
Water Consumption: 6 Star, 4.5L/Min
Brushed Gold

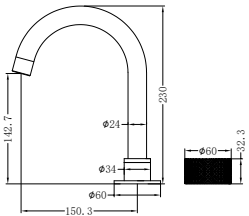
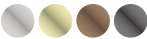

S652GL

SOLE Progressive Tall Basin Set
Water Consumption: 5 Star, 6L/Min
Brushed Gold

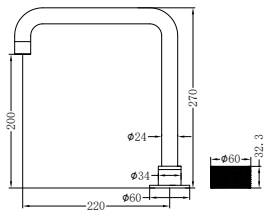
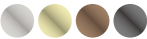

S251-23GL

SOLE Progressive Bath and Shower System
With Spout 230mm
Water Consumption: 7.5L/Min
Brushed Gold

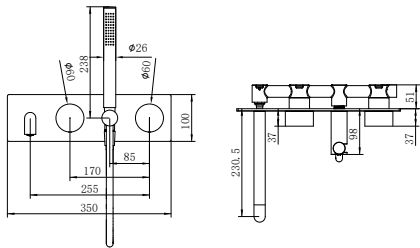
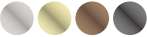

S251-25GL

SOLE Progressive Bath and Shower System
With Spout 250mm
Water Consumption: 7.5L/Min
Brushed Gold

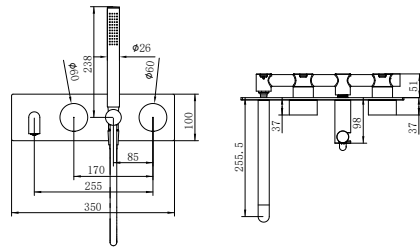

S250-23GL

SOLE Progressive Bath and Shower System
Separate Plate With Spout 230mm
Water Consumption: 7.5L/Min
Brushed Gold

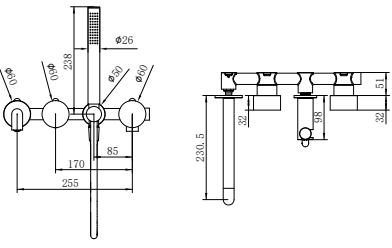

S669-13GL/S669-17GL S669-20GL/
S669-24GL
S669-27GL

SOLE Progressive Wall Basin/Bath Set 120mm
/160mm/185mm/230mm/260mm Spout
Water Consumption: 5 Star, 6L/Min
Brushed Gold

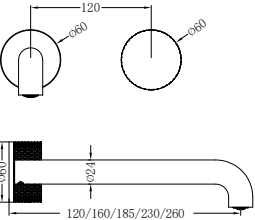
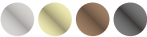

S519GL

SOLE Progressive Pull Out Kitchen Set
Water Consumption: 6 Star, 4.5L/Min
Brushed Gold

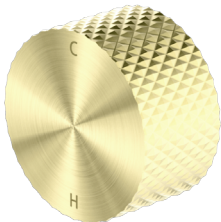
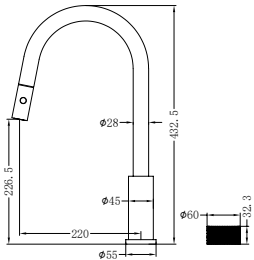
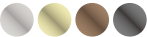

S605GL

SOLE Progressive Shower Mixer
Water Consumption: N/A
Brushed Gold

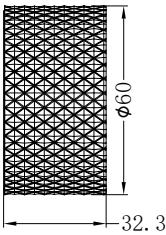

S250-25GL

SOLE Progressive Bath and Shower System
Separate Plate With Spout 250mm
Water Consumption: 7.5L/Min
Brushed Gold

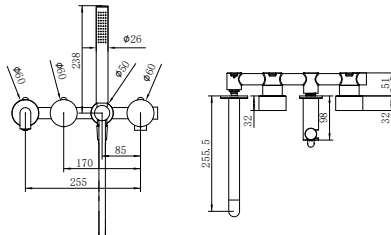
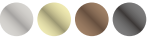

S681GL

SOLE Progressive Shower System
Water Consumption: 7.5L/Min
Brushed Gold

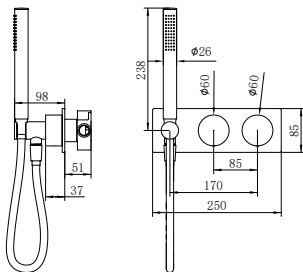
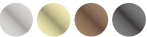

S680GL

SOLE Progressive Shower System
Separate Plate
Water Consumption: 7.5L/Min
Brushed Gold

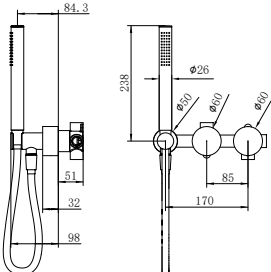
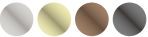



S651BB

SOLE Progressive Basin Set
Water Consumption: 6 Star, 4.5L/Min
Brushed Copper

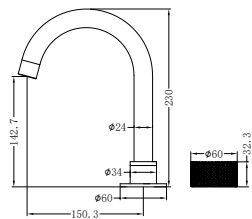
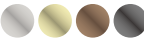

S652BB

SOLE Progressive Tall Basin Set
Water Consumption: 5 Star, 6L/Min
Brushed Copper

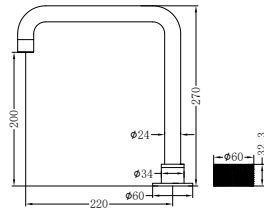
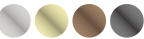

S669-13BB/S669-17BB S669-20BB/
S669-24BB
S669-27BB

SOLE Progressive Wall Basin/Bath Set 120mm
/160mm/185mm/230mm/260mm Spout
Water Consumption: 5 Star, 6L/Min
Brushed Copper

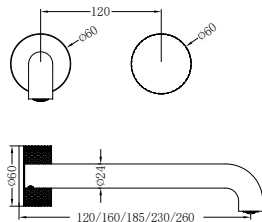

S519BB

SOLE Progressive Pull Out Kitchen Set
Water Consumption: 6 Star, 4.5L/Min
Brushed Copper

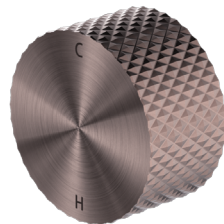
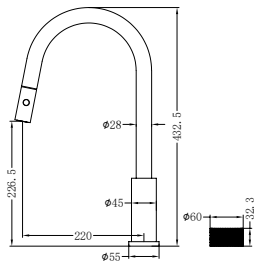
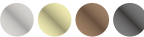

S605BB

SOLE Progressive Shower Mixer
Water Consumption: N/A
Brushed Copper

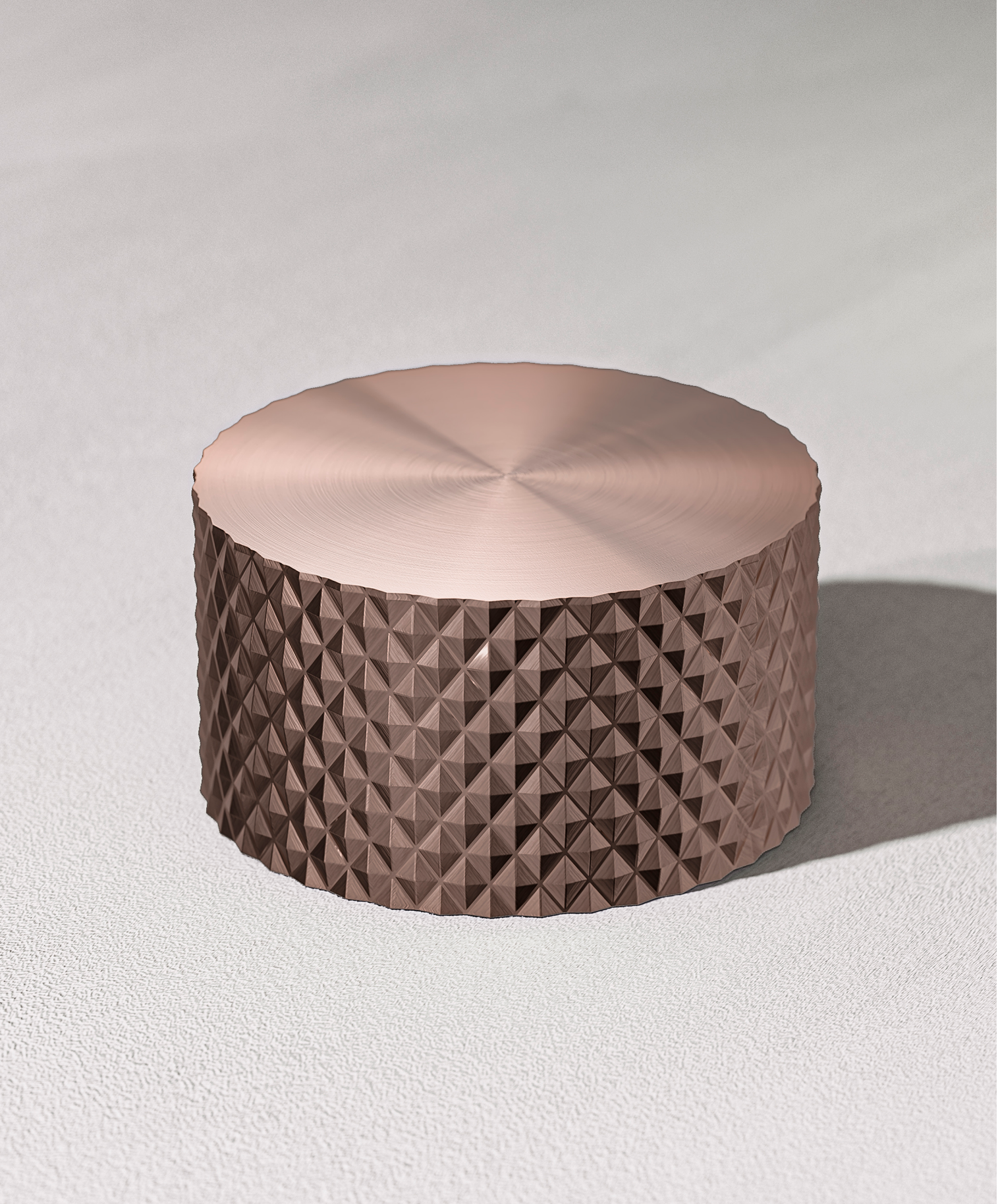
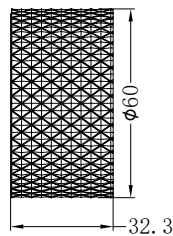
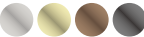

Built-in Progressive
shower mixer



Built-in Progressive Shower System



S251-23BB

SOLE Progressive Bath and Shower System
With Spout 230mm
Water Consumption: 7.5L/Min
Brushed Copper

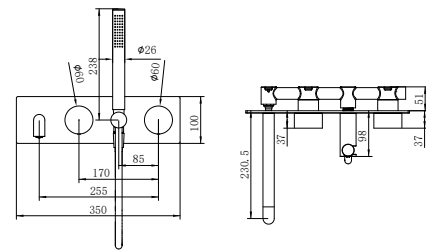

S250-25BB

SOLE Progressive Bath and Shower System
Separate Plate With Spout 250mm
Water Consumption: 7.5L/Min
Brushed Copper

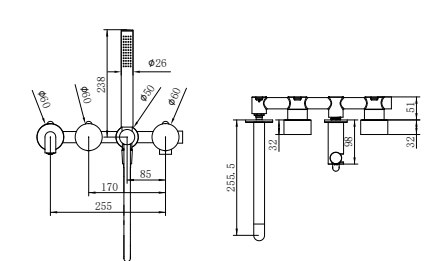

S251-25BB

SOLE Progressive Bath and Shower System
With Spout 250mm
Water Consumption: 7.5L/Min
Brushed Copper

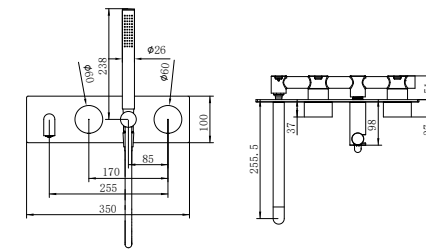

S681BB

SOLE Progressive Shower System
Water Consumption: 7.5L/Min
Brushed Copper

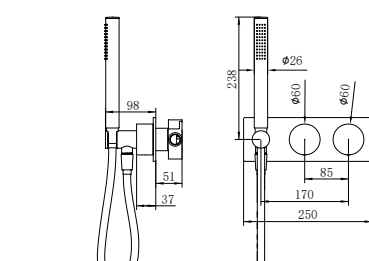
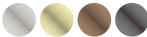

S250-23BB

SOLE Progressive Bath and Shower System
Separate Plate With Spout 230mm
Water Consumption: 7.5L/Min
Brushed Copper

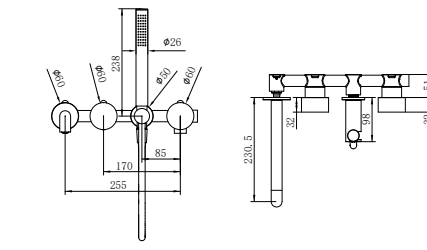

S680BB

SOLE Progressive Shower System
Separate Plate
Water Consumption: 7.5L/Min
Brushed Copper

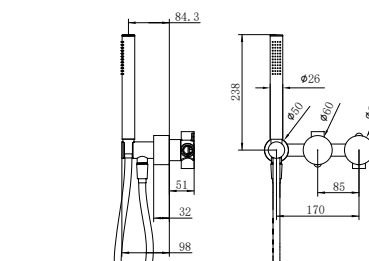



S651GB

SOLE Progressive Basin Set
Water Consumption: 6 Star, 4.5L/Min
Brushed Graphite

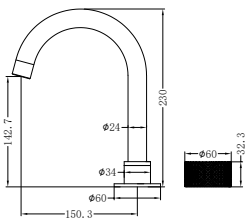
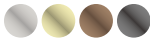

S652GB

SOLE Progressive Tall Basin Set
Water Consumption: 5 Star, 6L/Min
Brushed Graphite

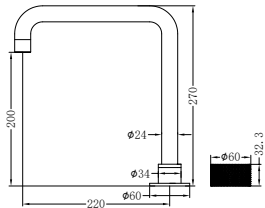
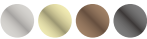

S669-13GB/S669-17GB
S669-20GB/S669-24GB
S669-27GB

SOLE Progressive Wall Basin/Bath Set 120mm
/160mm/185mm/230mm/260mm Spout
Water Consumption: 5 Star, 6L/Min
Brushed Graphite

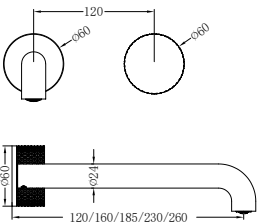

S519GB

SOLE Progressive Pull Out Kitchen Set
Water Consumption: 6 Star, 4.5L/Min
Brushed Graphite

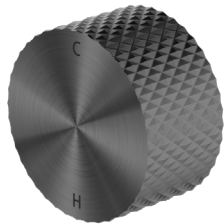
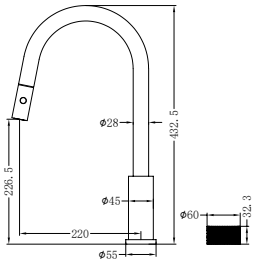
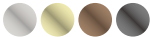

S605GB

SOLE Progressive Shower Mixer
Water Consumption: N/A
Brushed Graphite

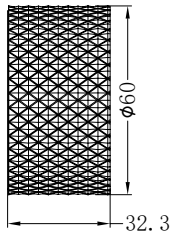
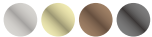

S251-23GB

SOLE Progressive Bath and Shower System
With Spout 230mm
Water Consumption: 7.5L/Min
Brushed Graphite

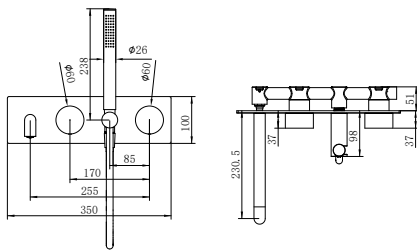

S251-25GB

SOLE Progressive Bath and Shower System
With Spout 250mm
Water Consumption: 7.5L/Min
Brushed Graphite

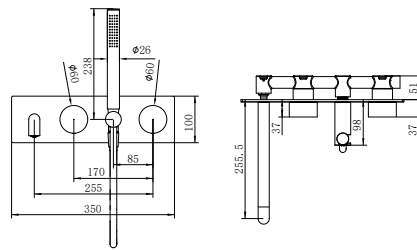

S250-23GB

SOLE Progressive Bath and Shower System
Separate Plate With Spout 230mm
Water Consumption: 7.5L/Min
Brushed Graphite

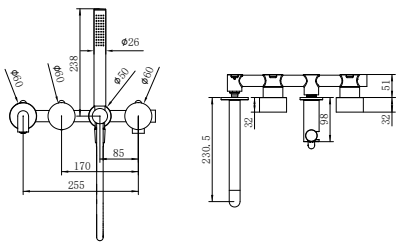

S250-25GB

SOLE Progressive Bath and Shower System
Separate Plate With Spout 250mm
Water Consumption: 7.5L/Min
Brushed Graphite

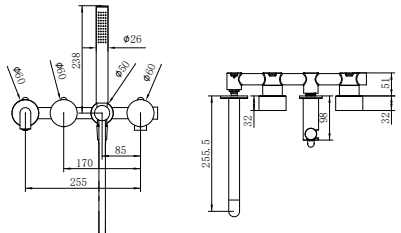

S681GB

SOLE Progressive Shower System
Water Consumption: 7.5L/Min
Brushed Graphite

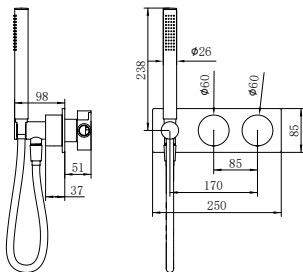
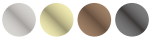

S680GB

SOLE Progressive Shower System
Separate Plate
Water Consumption: 7.5L/Min
Brushed Graphite

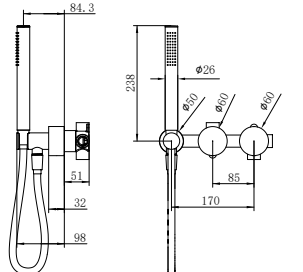

S360CN
SOLE Freestanding Bath and Shower Mixer
Water Consumption: 3 Star, 9L/Min
Brushed Nickel

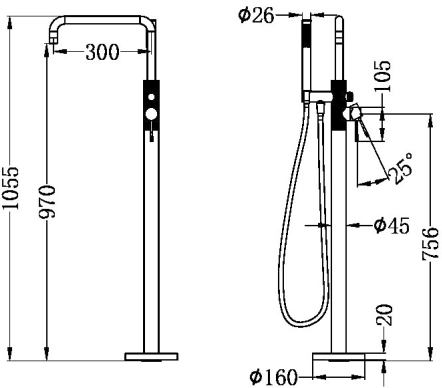

S359CN
SOLE Freestanding Basin Mixer
Water Consumption: 3 Star, 9L/Min
Brushed Nickel

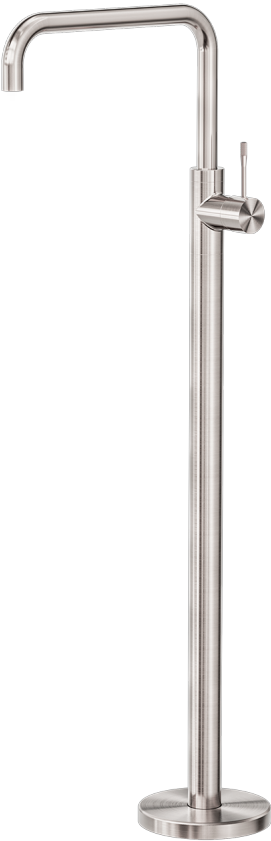
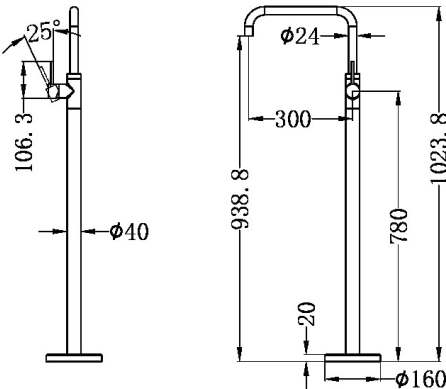
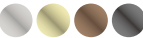

Brushed Gold
S360GL

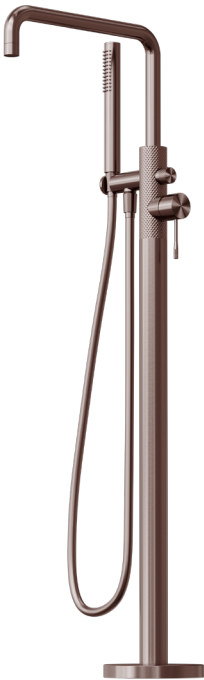

Brushed Copper
S360BB



Brushed Graphite
S360GB

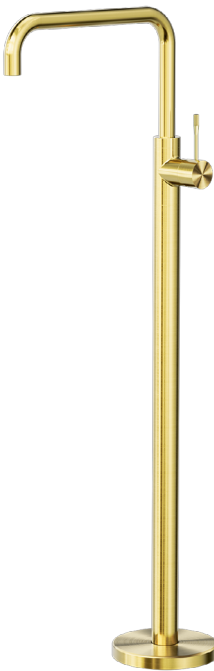

Brushed Gold
S359GL

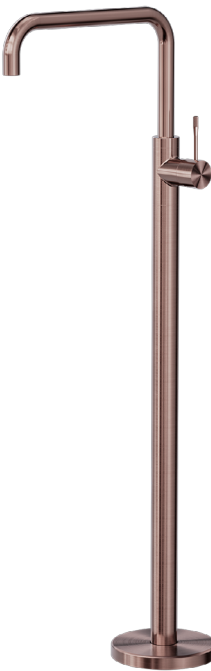

Brushed Copper
S359BB

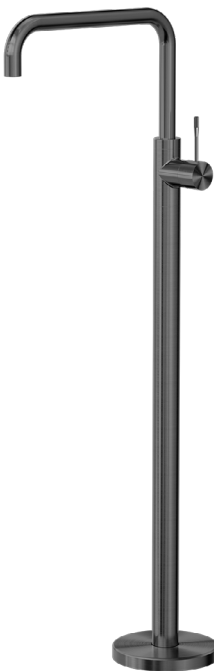

Brushed Graphite
S359GB



BATHROOM ACCESSORIES

- Brushed Nickel
- Brushed Copper
- Brushed Gold
- Brushed Graphite

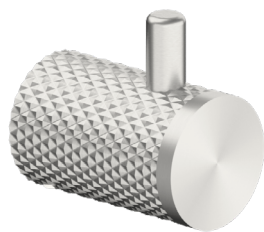

S301CN

SOLE Robe Hook
Brushed Nickel

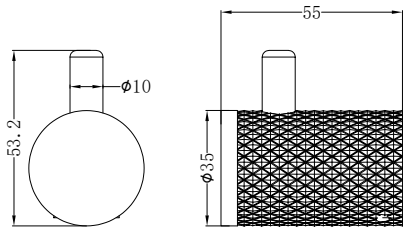
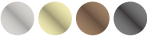

S304CN

SOLE Toilet Roll Holder
Brushed Nickel

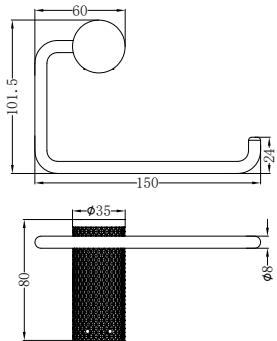

S306CN

SOLE Towel Ring
Brushed Nickel

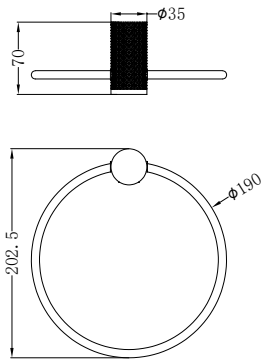
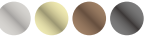

S303CN

SOLE Soap Dish Holder
Brushed Nickel

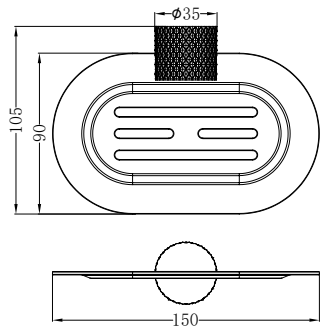

S308CN

SOLE Single Towel Rail 600mm
Brushed Nickel

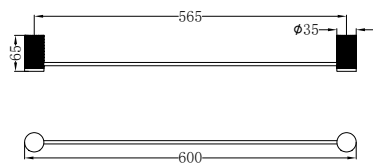

S308HCN

SOLE Single Towel Rail 800mm
Brushed Nickel

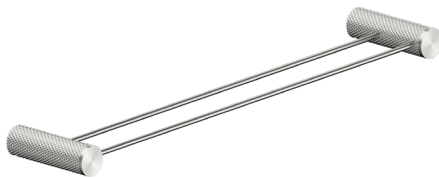
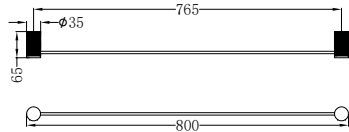

S310CN

SOLE Double Towel Rail 600mm
Brushed Nickel

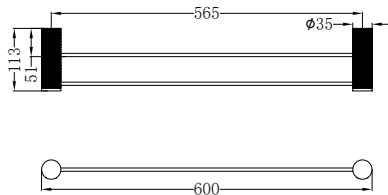
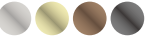

S310HCN

SOLE Double Towel Rail 800mm
Brushed Nickel

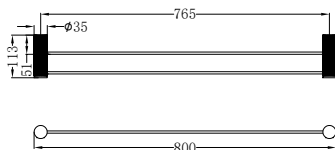

S309CN

SOLE Metal Shower Shelf
Brushed Nickel

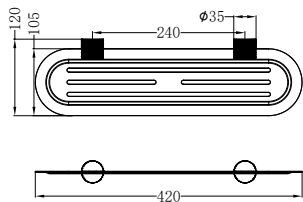

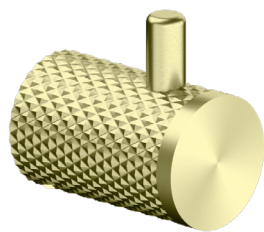

S301GL

SOLE Robe Hook
Brushed Gold

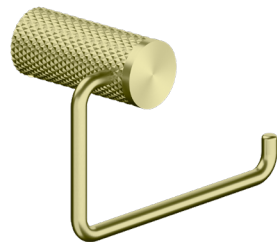
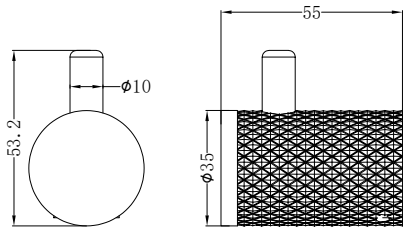
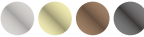

S304GL

SOLE Toilet Roll Holder
Brushed Gold

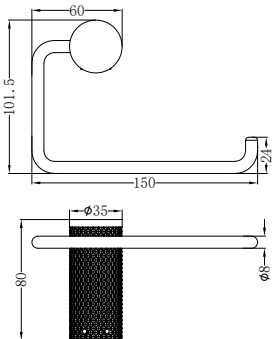

S306GL

SOLE Towel Ring
Brushed Gold

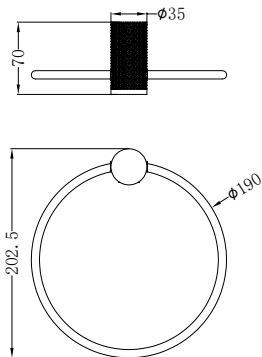

S303GL

SOLE Soap Dish Holder
Brushed Gold

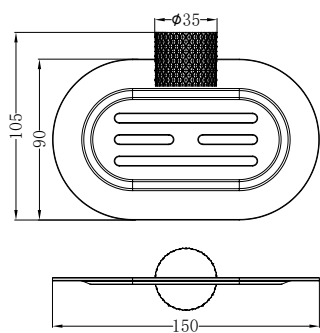



S310GL

SOLE Double Towel Rail 600mm
Brushed Gold

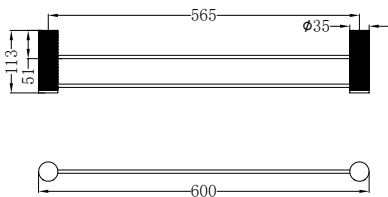

S308GL

SOLE Single Towel Rail 600mm
Brushed Gold

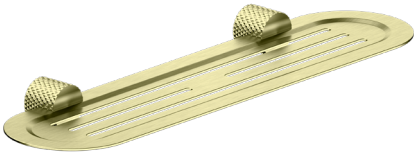
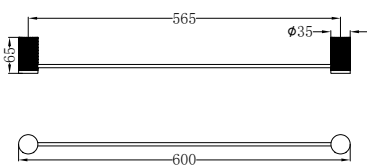

S309GL

SOLE Metal Shower Shelf
Brushed Gold

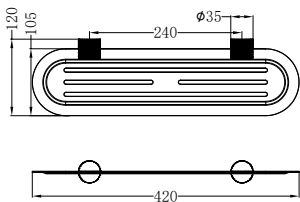

S310HGL

SOLE Double Towel Rail 800mm
Brushed Gold

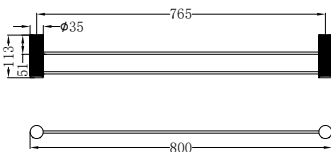

S308HGL

SOLE Single Towel Rail 800mm
Brushed Gold

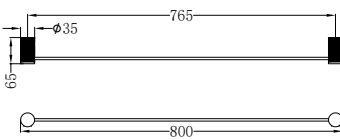

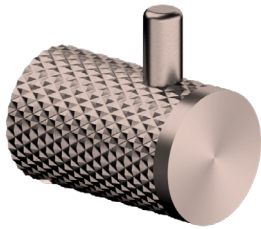

S301BB

SOLE Robe Hook
Brushed Copper

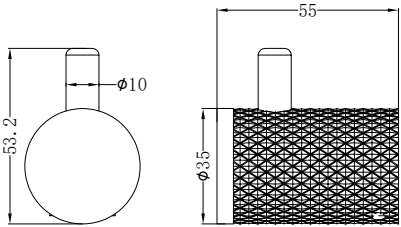
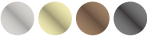

S304BB

SOLE Toilet Roll Holder
Brushed Copper

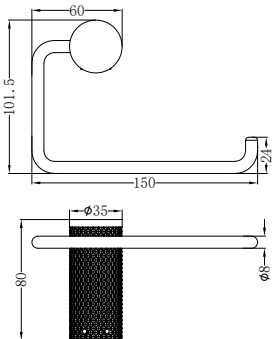

S306BB

SOLE Towel Ring
Brushed Copper

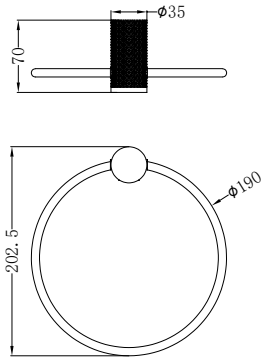

S303BB

SOLE Soap Dish Holder
Brushed Copper

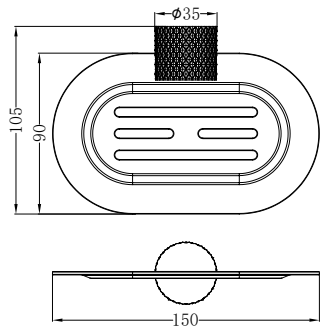

S308BB

SOLE Single Towel Rail 600mm
Brushed Copper

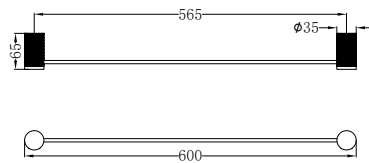

S308HBB

SOLE Single Towel Rail 800mm
Brushed Copper

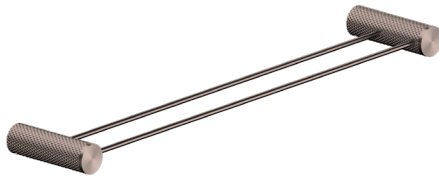
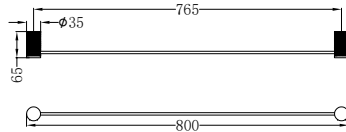

S310BB

SOLE Double Towel Rail 600mm
Brushed Copper

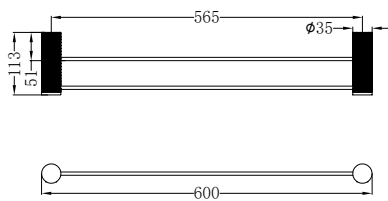
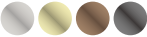

S310HBB

SOLE Double Towel Rail 800mm
Brushed Copper

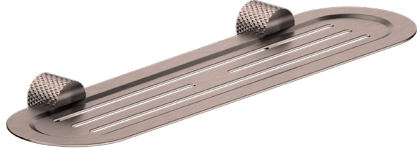
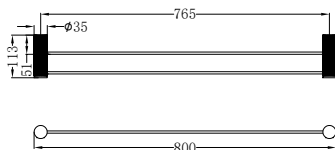

S309BB

SOLE Metal Shower Shelf
Brushed Copper

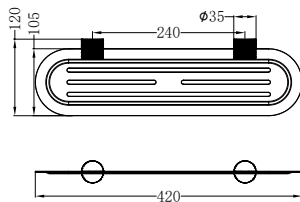



S301GB

SOLE Robe Hook
Brushed Graphite

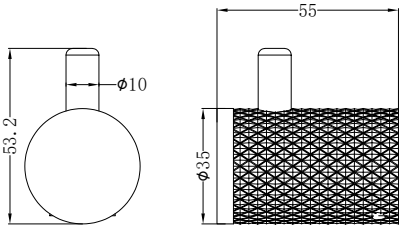
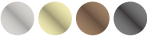

S304GB

SOLE Toilet Roll Holder
Brushed Graphite

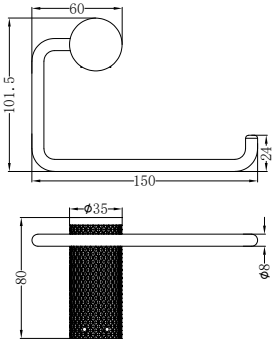

S306GB

SOLE Towel Ring
Brushed Graphite

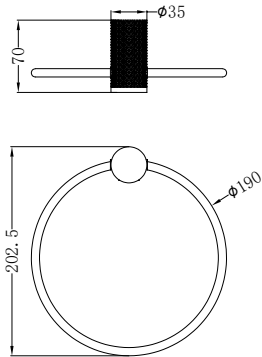
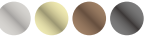

S303GB

SOLE Soap Dish Holder
Brushed Graphite

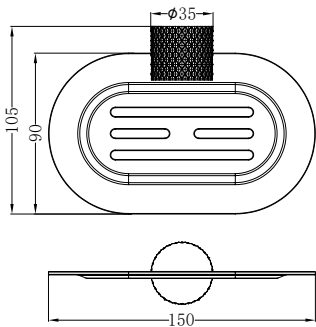

S308GB

SOLE Single Towel Rail 600mm
Brushed Graphite

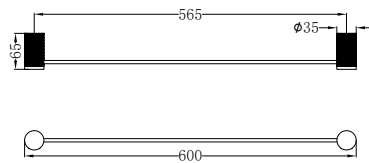

S308HGB

SOLE Single Towel Rail 800mm
Brushed Graphite

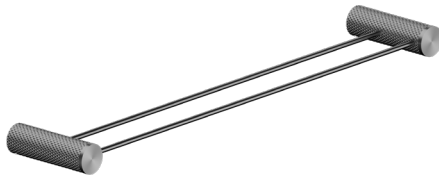
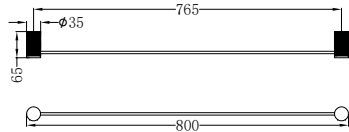

S310GB

SOLE Double Towel Rail 600mm
Brushed Graphite

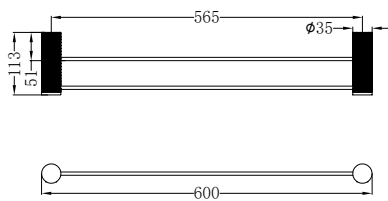
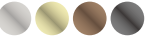

S310HGB

SOLE Double Towel Rail 800mm
Brushed Graphite

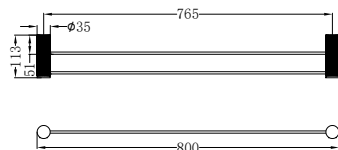

S309GB

SOLE Metal Shower Shelf
Brushed Graphite

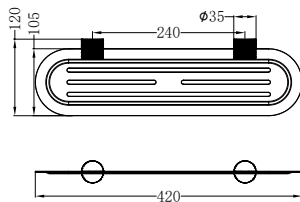

SHOWER PROGRAM

- Brushed Nickel
- Brushed Copper
- Brushed Gold
- Brushed Graphite



SOLE Shower Bracket With Air Shower
Water Consumption: 3 Star, 9L/Min

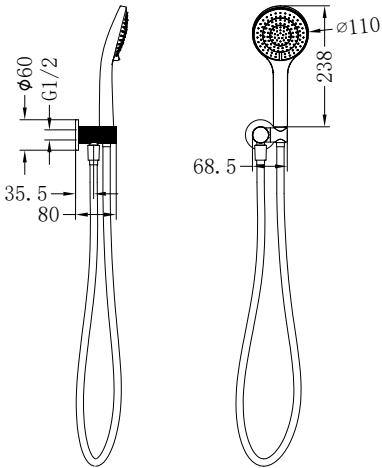

Brushed Nickel
S218CN



Brushed Gold
S218GL

SOLE Shower System with G1/2 Water Outlet Inside. Water Switch
For 2 Streams. Air Hand Shower.
Water Consumption: Overhead Shower 3 Star, 9L/Min
Hand Shower 3 Star, 9L/Min

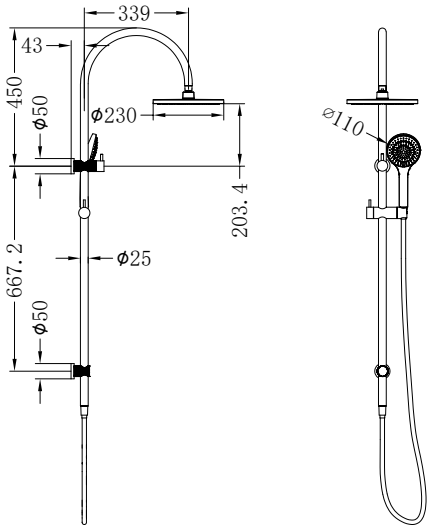

Brushed Nickel
S7117-10CN



Brushed Gold
S7117-10GL

SOLE Shower Rail With G1/2 Water Outlet Inside. Air Hand Shower.
Water Consumption: 3 Star, 9L/Min

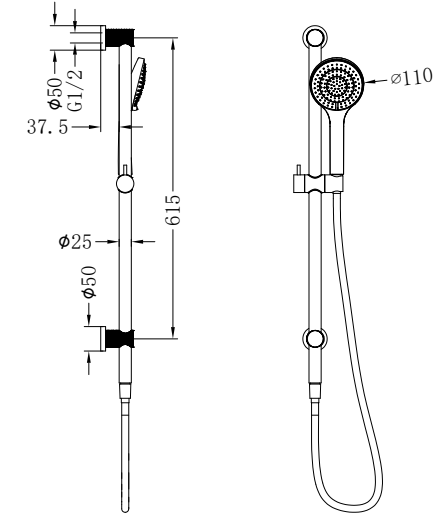

Brushed Nickel
S782CN



Brushed Gold
S782GL



S219CN

SOLE Shower Bracket with Air Hand Shower
Water Consumption: 3 Star, 9L/Min
Brushed Nickel

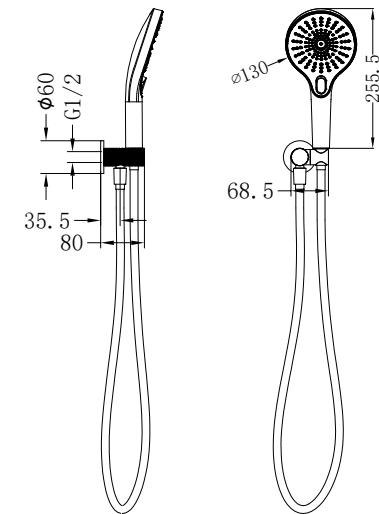

S783CN

SOLE Shower Rail With G1/2 Water Outlet Inside. Air Hand Shower.
Water Consumption: 3 Star, 9L/Min
Brushed Nickel

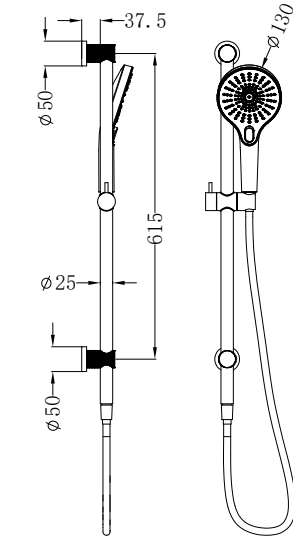

Brushed Gold
S219GL



Brushed Copper
S219BB



Brushed Graphite
S219GB



Brushed Gold
S783GL



Brushed Copper
S783BB



Brushed Graphite
S783GB

S7118-10CN

SOLE Shower System with G1/2 Water Outlet Inside. Water Switch
For 2 Streams. Air Hand Shower.
Water Consumption: Overhead Shower 3 Star, 9L/Min
Hand Shower 3 Star, 9L/Min
Brushed Nickel

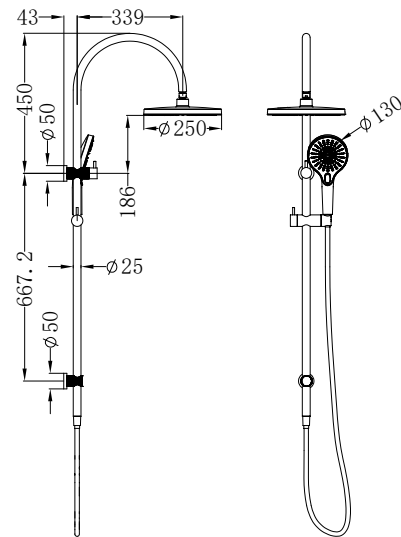
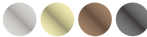

Brushed Gold
S7118-10GL

Brushed Copper
S7118-10BB

Brushed Graphite
S7118-10GB





Air Shower II

Air Shower going to completely transform the way you look at showering.

Our product development team have redesigned the shower nozzles with 4 times as many holes compared as it in general for an even more delicate splash and lighter, airier feel.

Hand-held Air shower II has 76 nodules, each with 4 holes, hence providing you with the ultimate showering experience. Air Shower also comes with increased functionality with the inclusion of superior decontamination. Forget the worries of clogging outlet holes due to water quality problems as you can get rid of residual deposits at a touch of a button.

This provides you with the same luxurious feel from the first time you experience it until the last.



Air Shower Mode



Water Mist Mode

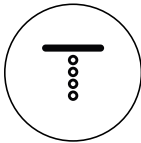

Microbubble Mode



Discover the Micro Bubble Technology in Air Shower II

Deep Clean, Deep Nourishment

Our shower's micro-bubbles have an incredibly small diameter, ranging from just 0.01 to 100 microns. This size is significantly smaller than human skin pores, which typically measure between 20 to 200 microns. Due to their minuscule size, these micro-bubbles can effortlessly penetrate the pores, reaching the deeper layers of the skin. This allows for a more effective and deeper cleaning compared to regular shower droplets, ensuring a thorough cleanse down to the microscopic level.

Effective Sterilization, Water Purification

Micro-bubble shower releases hydroxyl radicals, known for potent oxidation. They quickly neutralize bacteria on skin and in water, ensuring deep sterilization. This makes our shower ideal for sensitive skin, transforming each use into a holistic skincare experience, promoting both cleanliness and skin health.



Efficient Oil Control, Gentle Cleanse

The micro-bubbles released by our shower are made up of nonpolar molecules with a hydrophobic nature, efficiently binding with oils and effectively removing them from the skin's surface. This ensures a prolonged feeling of freshness while minimizing any unwanted shine. This is particularly beneficial for oily or acne-prone skin, aiding in oil control and preventing blemishes. It improves the skin's texture, making it softer and smoother.



Baby-Friendly Bathing

The fine micro-bubbles generated ensure that a baby's delicate skin remains untouched by harsh water streams, creating a safer and more comforting bathing experience. The powerful sterilizing effect is especially crucial for babies. Let your baby love the bath and enjoy it.

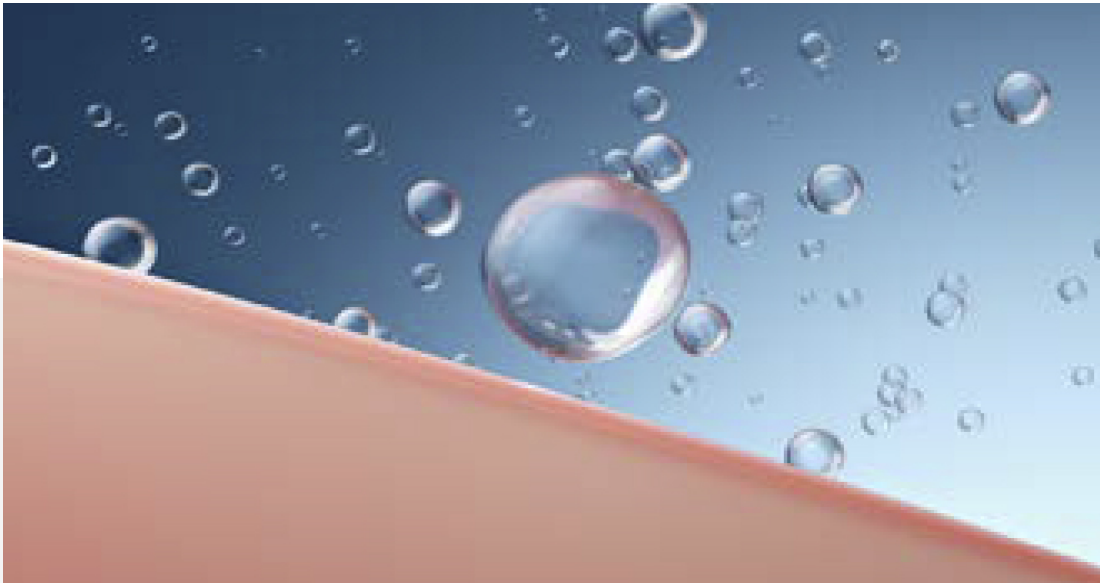

S220CN

SOLE Shower Bracket With Air Shower II
Water Consumption: 3 Star, 9L/Min
Brushed Nickel

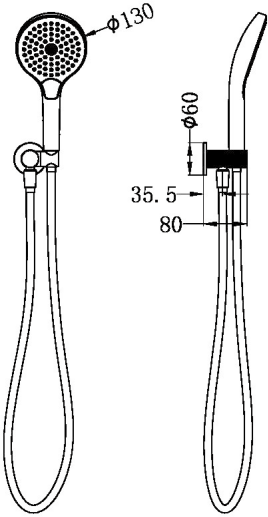

S784CN

SOLE Shower Rail With G1/2 Water Outlet Inside. Air Hand Shower.
Water Consumption: 3 Star, 9L/Min
Brushed Nickel

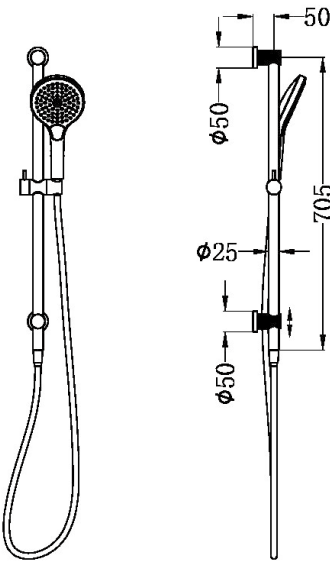

Brushed Gold
S220GL



Brushed Copper
S220BB



Brushed Graphite
S220GB



Brushed Gold
S784GL



Brushed Copper
S784BB



Brushed Graphite
S784GB

SOLE Shower System with G1/2 Water Outlet Inside. Water Switch For 2 Streams.
Air Hand Shower II. Brass Top Shower Head.
Water Consumption: Overhead Shower 3 Star, 9L/Min
Hand Shower 3 Star, 9L/Min
Brushed Nickel



Thermostatic wall-mounted mixer for 2 streams
Water Consumption: N/A
Brushed Nickel

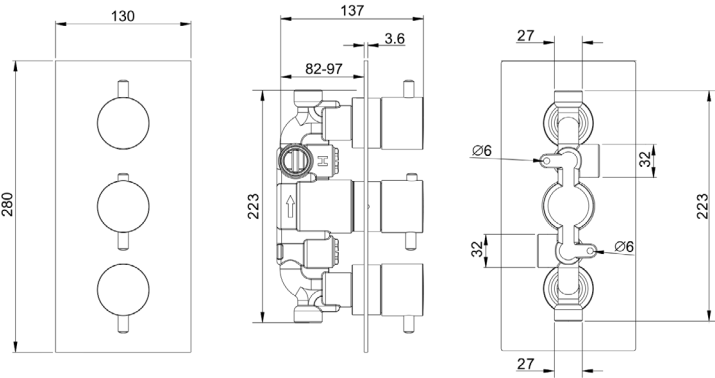

Brushed Graphite
S616T2WGB



S790-10CN

250mm SOLE Air Shower Head
Water Consumption: 3 Star, 9L/Min
Brushed Nickel

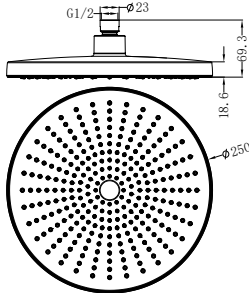
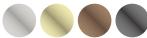

S789-10CN

230mm SOLE Air Shower Head
Water Consumption: 3 Star, 9L/Min
Brushed Nickel

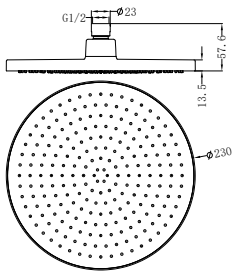

S040CN

SOLE Air Hand Shower
Water Rating: 3 Star, 9L/Min
Brushed Nickel

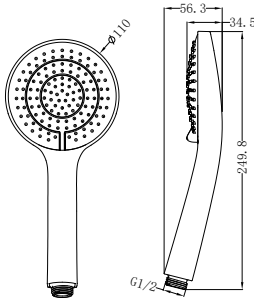

S041CN

SOLE Air Hand Shower
Water Consumption: 3 Star, 9L/Min
Brushed Nickel

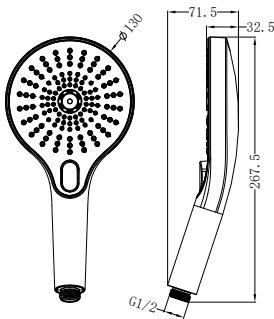
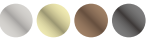

S042CN

SOLE Air II Hand Shower
Water Consumption: 3 Star, 9L/Min
Brushed Nickel

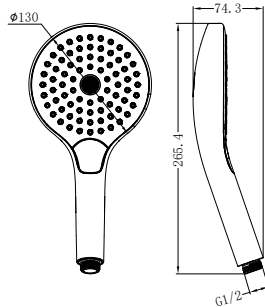
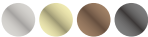

S790-10GL

250mm SOLE Air Shower Head
Water Consumption: 3 Star, 9L/Min
Brushed Gold

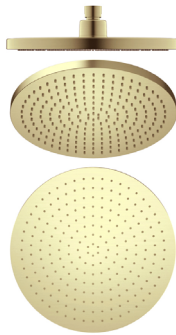
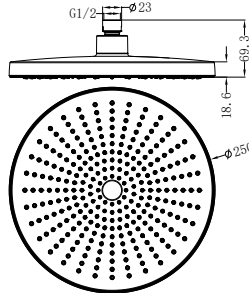
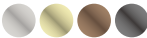

S789-10GL

230mm SOLE Air Shower Head
Water Consumption: 3 Star, 9L/Min
Brushed Gold

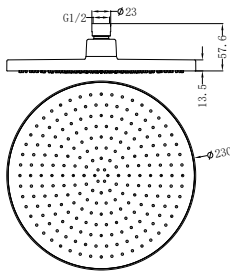

S040GL

SOLE Air Hand Shower
Water Rating: 3 Star, 9L/Min
Brushed Gold

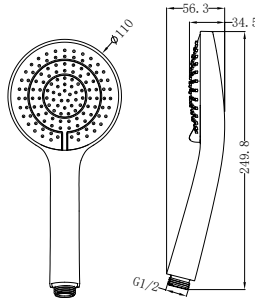

S041GL

SOLE Air Hand Shower
Water Consumption: 3 Star, 9L/Min
Brushed Gold

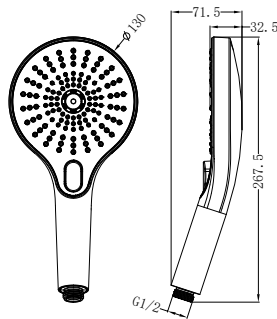
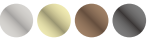

S042GL

SOLE Air II Hand Shower
Water Consumption: 3 Star, 9L/Min
Brushed Gold

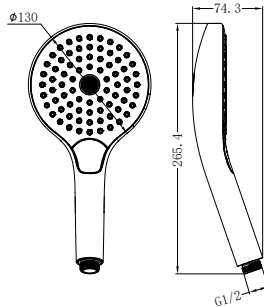
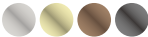



S790-10BB

250mm SOLE Air Shower Head
Water Consumption: 3 Star, 9L/Min
Brushed Copper

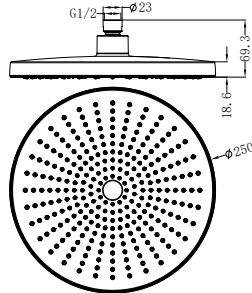
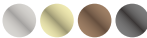

S042BB

SOLE Air II Hand Shower
Water Consumption: 3 Star, 9L/Min
Brushed Copper

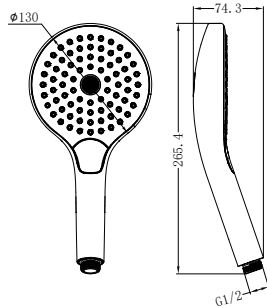
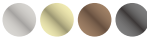

S041BB

SOLE Air Hand Shower
Water Consumption: 3 Star, 9L/Min
Brushed Copper

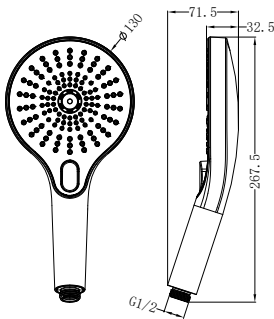
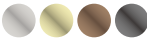

S041GB

SOLE Air Hand Shower
Water Consumption: 3 Star, 9L/Min
Brushed Graphite

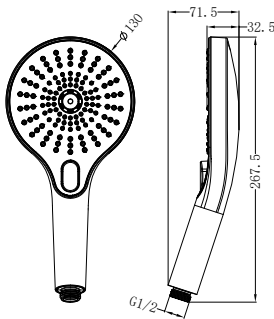
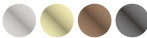

S790-10GB

250mm SOLE Air Shower Head
Water Consumption: 3 Star, 9L/Min
Brushed Graphite

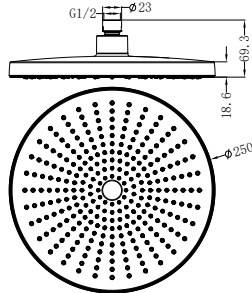
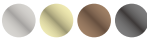

S042GB

SOLE Air II Hand Shower
Water Consumption: 3 Star, 9L/Min
Brushed Graphite

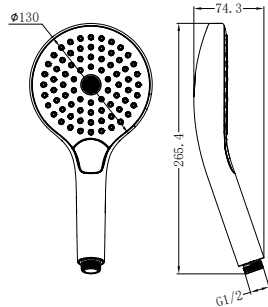
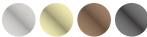



S765GB
Round Wall Shower Arm 350mm Length
Water Consumption: N/A
Brushed Graphite

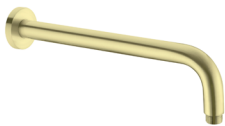
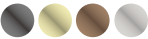

Brushed Gold
S765GL



Brushed Copper
S765BB



Brushed Nickel
S765CN

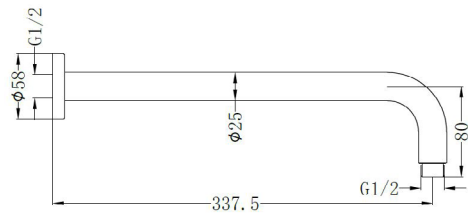

S766-15GB, S766-30GB
Round Ceiling Shower Arm 150mm/300mm Length
Wels Consumption: N/A
Brushed Graphite

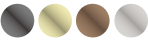

Brushed Gold
S766-15GL
S766-30GL

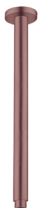

Brushed Copper
S766-15BB
S766-30BB



Brushed Nickel
S766-15CN
S766-30CN

S041GB

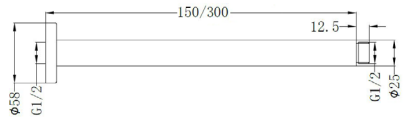

OTHER PRODUCTS

- Brushed Nickel
- Brushed Copper
- Brushed Gold
- Brushed Graphite





S401CN

Square 400mm Stainless Steel Basin
Brushed Nickel

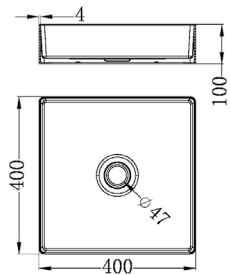

S403CN

Round 400mm Stainless Steel Basin
Brushed Nickel

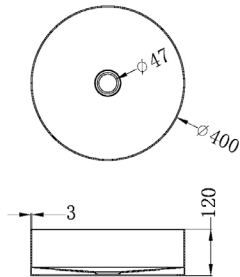

S402CN

Rectangle Stainless Steel Basin
Brushed Nickel

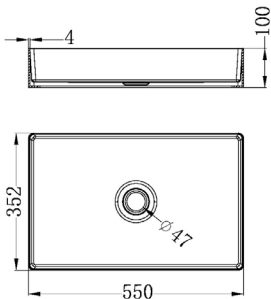

S083CN

Universal Pop Up Waste
Brushed Nickel

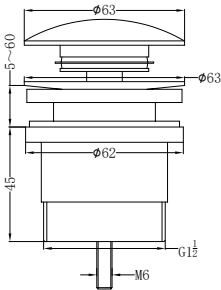

S082CN

40mm Bath Pop-Up Plug With Removable Waste No Overflow
Brushed Nickel

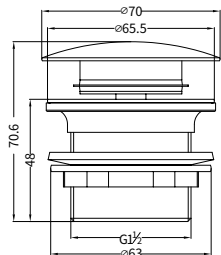

S070CN

900mm Tile Insert Rectangular Floor Waste 50mm Outlet

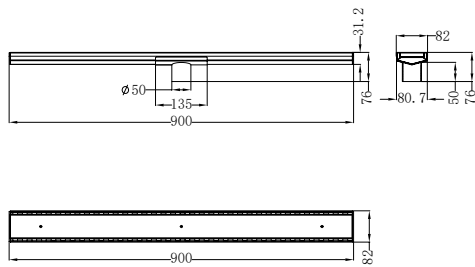

S067CN/S068CN

100mm/130mm Round Tile Insert Floor Waste 50mm/79mm Outlet
Brushed Nickel

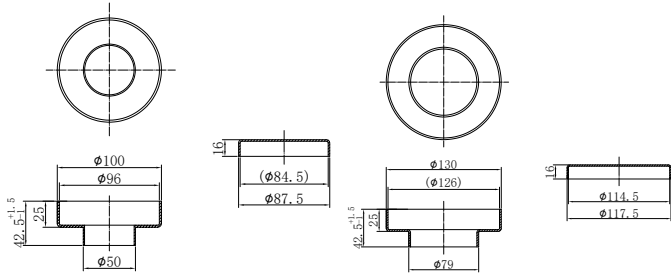

S052CN

Corner Tap Set G1/2xG1/2
Brushed Nickel

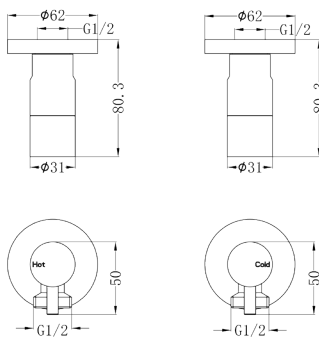



S401GL

Square 400mm Stainless Steel Basin
Brushed Gold

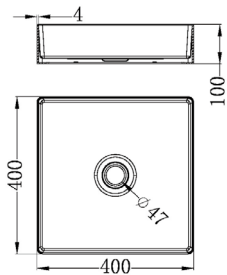
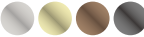

S403GL

Round 400mm Stainless Steel Basin
Brushed Gold

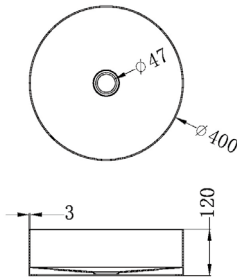

S402GL

Rectangle Stainless Steel Basin
Brushed Gold

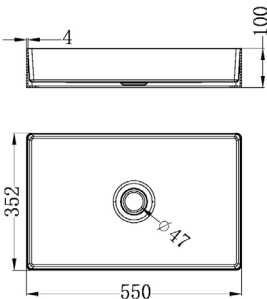
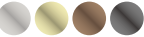

S083GL

Universal Pop Up Waste
Brushed Gold

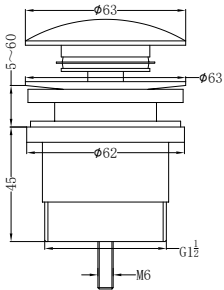

S082GL

40mm Bath Pop-Up Plug With Removable Waste No Overflow
Brushed Gold

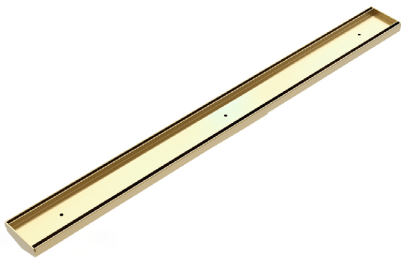
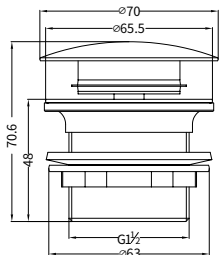
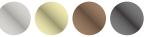

S070GL

900mm Tile Insert Rectangular Floor Waste 50mm Outlet
Brushed Gold

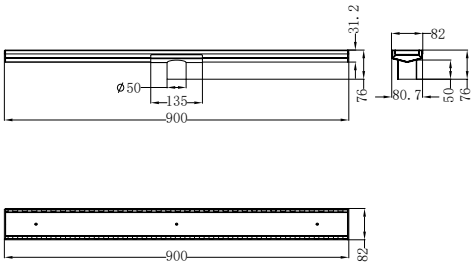

S067GL/S068GL

100mm/130mm Round Tile Insert Floor Waste 50mm/79mm Outlet
Brushed Gold

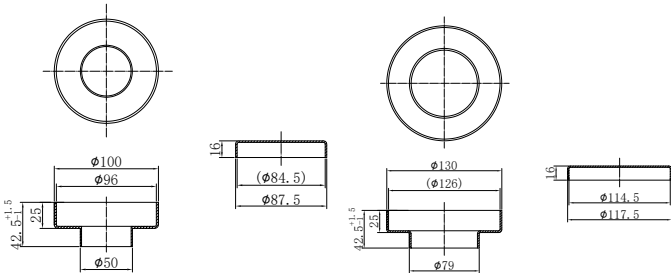
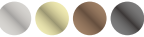

S052GL

Corner Tap Set G1/2xG1/2
Brushed Gold

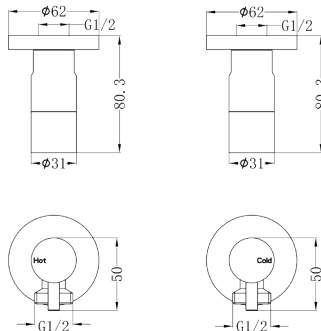



S401BB

Square 400mm Stainless Steel Basin
Brushed Copper

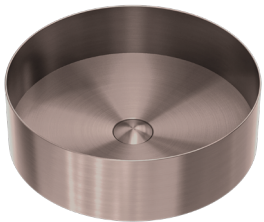
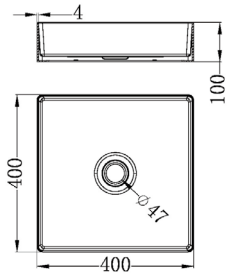
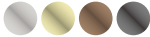

S403BB

Round 400mm Stainless Steel Basin
Brushed Copper

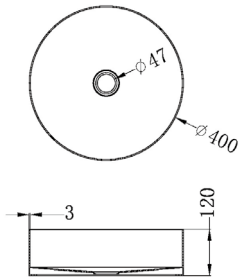

S402BB

Rectangle Stainless Steel Basin
Brushed Copper

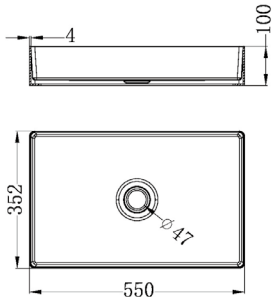

S083BB

Universal Pop Up Waste
Brushed Copper

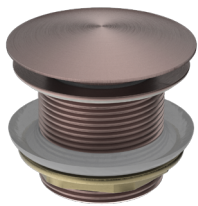
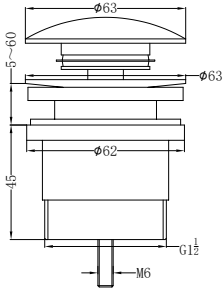

S082BB

40mm Bath Pop-Up Plug With Removable Waste No Overflow
Brushed Copper

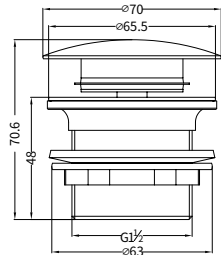
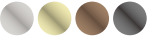

S070BB

900mm Tile Insert Rectangular Floor Waste 50mm Outlet
Brushed Copper

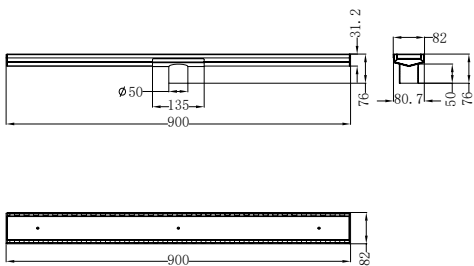

S067BB/S068BB

100mm/130mm Round Tile Insert Floor Waste 50mm/79mm Outlet
Brushed Copper

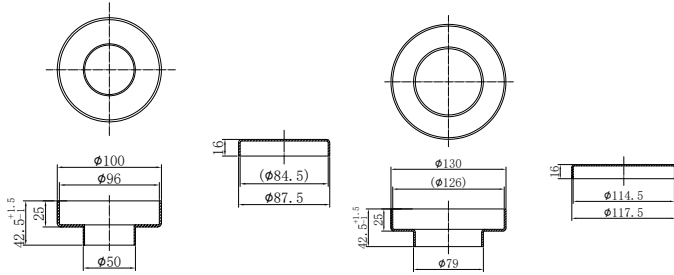
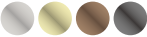

S052BB

Corner Tap Set G1/2xG1/2
Brushed Copper

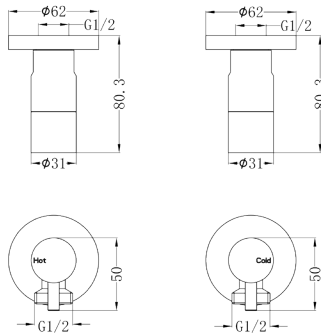



S401GB

Square 400mm Stainless Steel Basin
Brushed Graphite

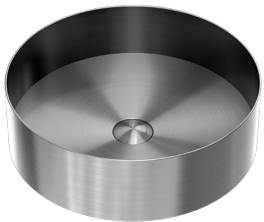
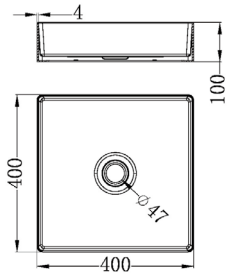
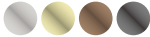

S403GB

Round 400mm Stainless Steel Basin
Brushed Graphite

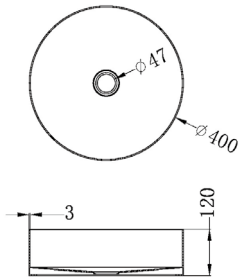

S402GB

Rectangle Stainless Steel Basin
Brushed Graphite

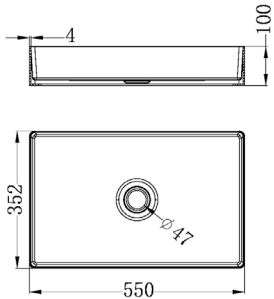
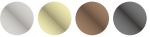

S083GB

Universal Pop Up Waste
Brushed Graphite

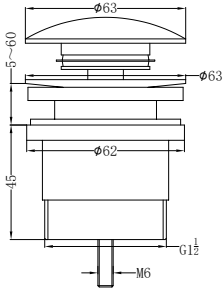

S082GB

40mm Bath Pop-Up Plug With Removable Waste No Overflow
Brushed Graphite

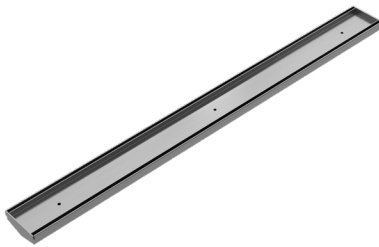
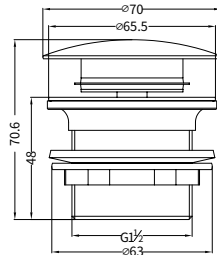
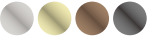

S070GB

900mm Tile Insert Rectangular Floor Waste 50mm Outlet
Brushed Graphite

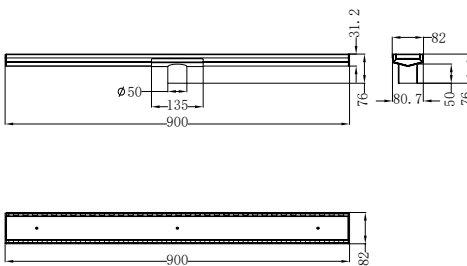
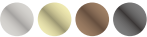

S067GB/S068GB

100mm/130mm Round Tile Insert Floor Waste 50mm/79mm Outlet
Brushed Graphite

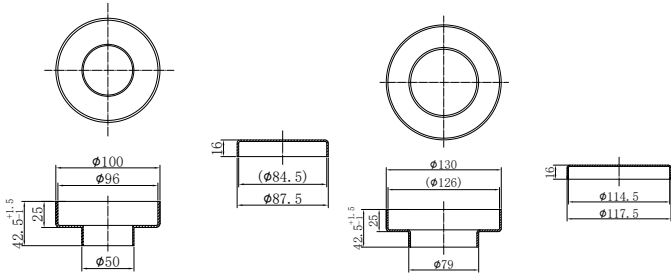
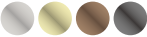

S052GB

Corner Tap Set G1/2xG1/2
Brushed Graphite

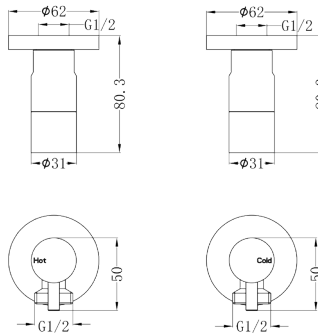
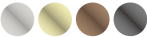



Heated Vertical Towel Rail

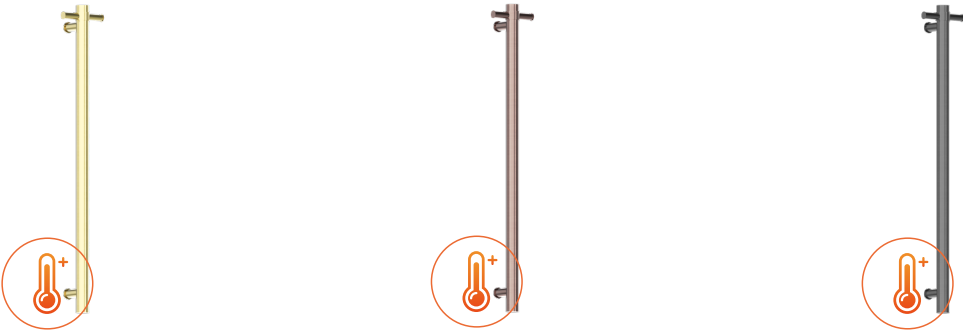

S410HGL, S410HBB, S410HGB

Heated Vertical Towel Rail
Brushed Gold, Brushed Copper, Brushed Graphite

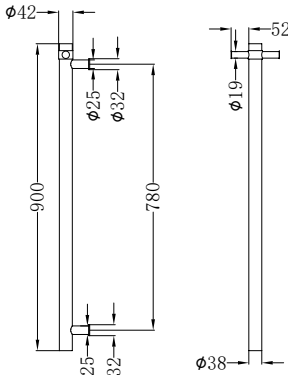

S418HGL/S418GL, S418HBB/S418BB, S418HGB/S418GB

Heated/Non-Heated Towel Ladder
Brushed Gold, Brushed Copper, Brushed Graphite

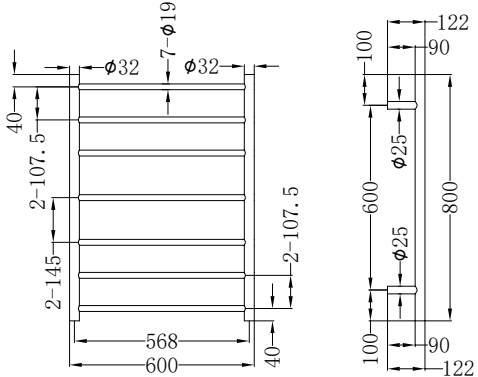



S431GL

90 Degree Glass to Wall Shower Hinge 10mm Glass
Brushed Gold

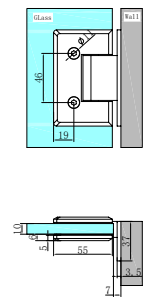

S432GL

180 Degree Glass to Glass Shower Hinge 10mm Glass
Brushed Gold

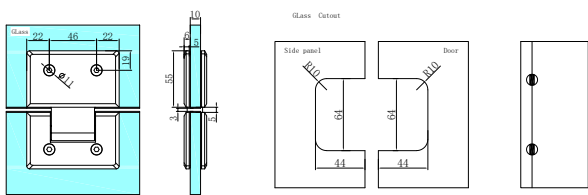

S436GL

90 Degree Glass to Wall Bracket 10mm Glass
Brushed Gold

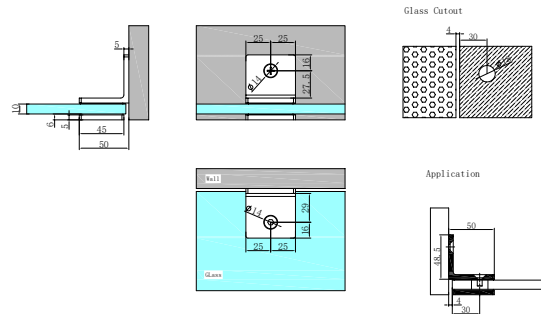

S437GL

Round Shower Knob
Brushed Gold

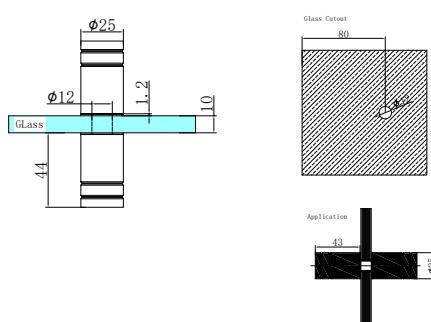

S433GL

Over-Panel Glass to Glass Fitting 10mm Glass
Brushed Gold

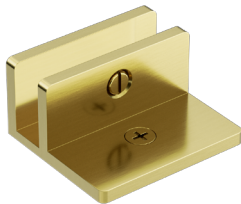
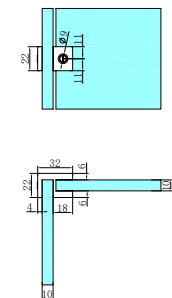

S434GL

Shower F Bracket 10mm Glass
Brushed Gold

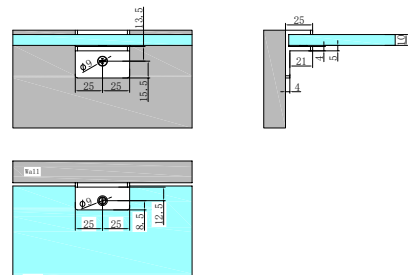

S435GL

Shower U Bracket 10mm Glass
Brushed Gold

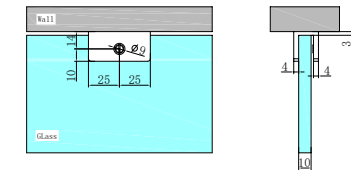

S441GL

Square Shower Knob Handle
Brushed Gold

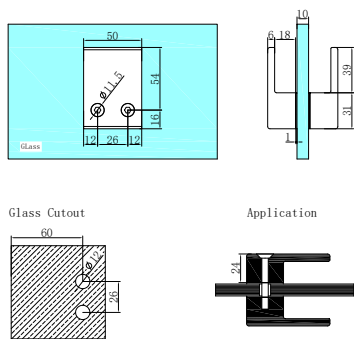

S442GL

Towel Bar 500mm
Brushed Gold

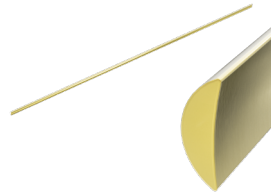
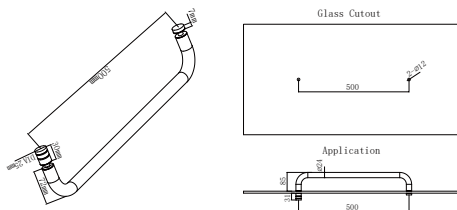

S438GL

Half Round Water Seal Rail 750mm
Brushed Gold

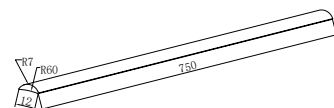

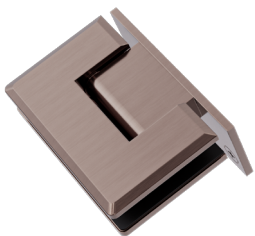

S431BB

90 Degree Glass to Wall Shower Hinge 10mm Glass
Brushed Copper

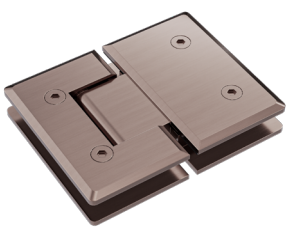
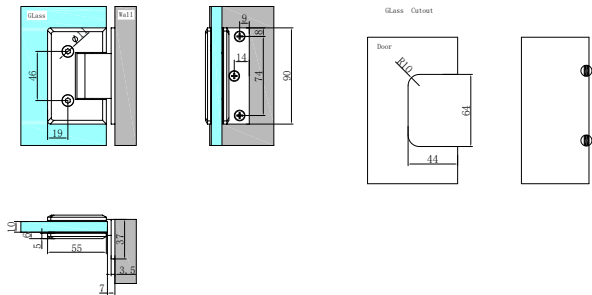

S432BB

180 Degree Glass to Glass Shower Hinge 10mm Glass
Brushed Copper

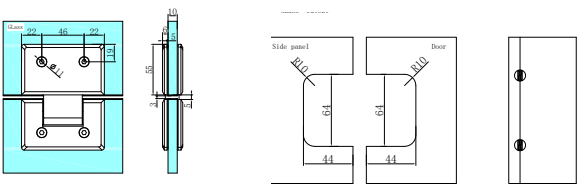

S436BB

90 Degree Glass to Wall Bracket 10mm Glass
Brushed Copper

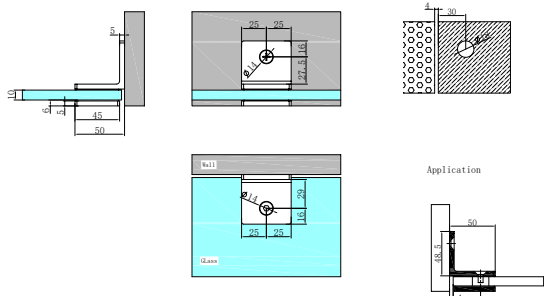

S437BB

Round Shower Knob
Brushed Copper

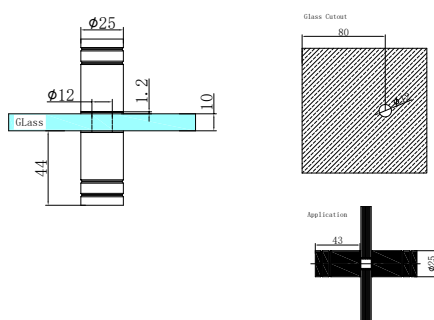

S433BB

Over-Panel Glass to Glass Fitting 10mm Glass
Brushed Copper

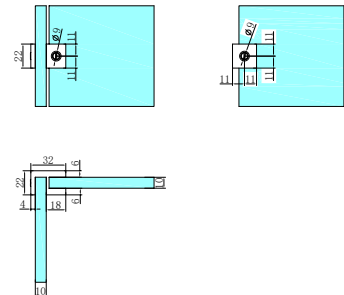

S434BB

Shower F Bracket 10mm Glass
Brushed Copper

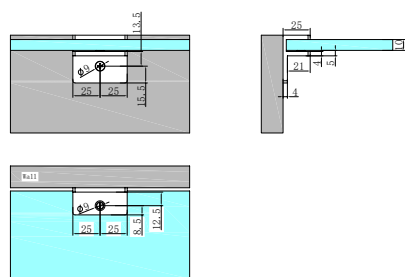

S435BB

Shower U Bracket 10mm Glass
Brushed Copper

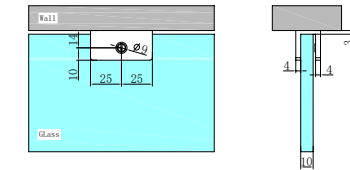

S441BB

Square Shower Knob Handle
Brushed Copper

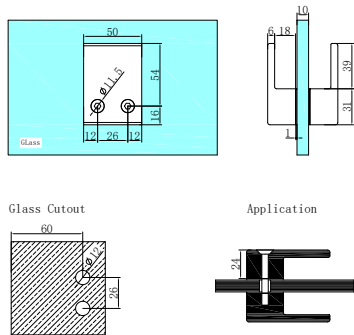

S442BB

Towel Bar 500mm
Brushed Copper

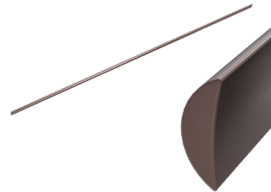
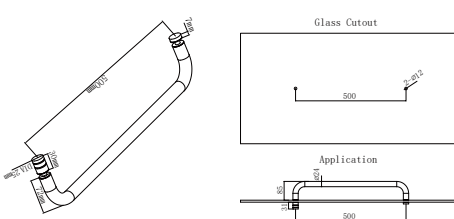

S438BB

Half Round Water Seal Rail 750mm
Brushed Copper

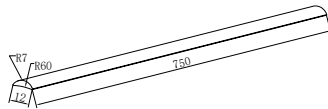



S431GB

90 Degree Glass to Wall Shower Hinge 10mm Glass
Brushed Graphite

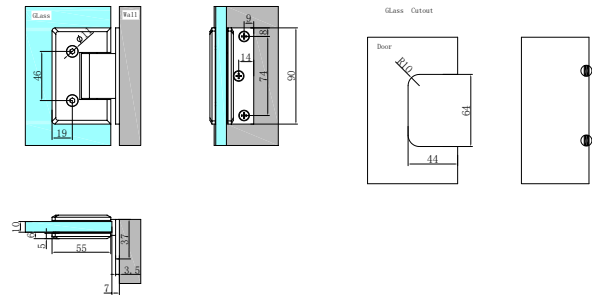

S432GB

180 Degree Glass to Glass Shower Hinge 10mm Glass
Brushed Graphite

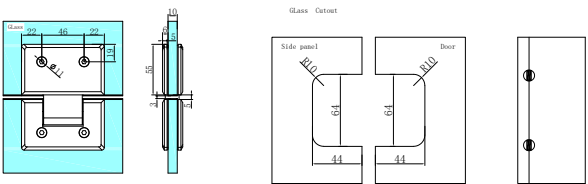

S436GB

90 Degree Glass to Wall Bracket 10mm Glass
Brushed Graphite

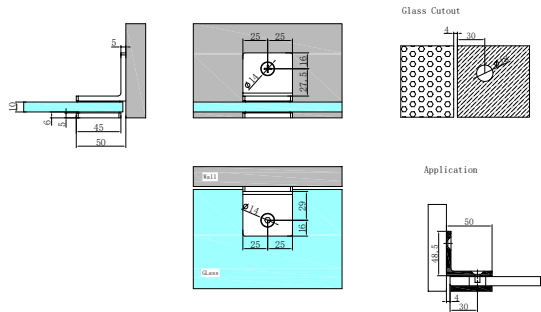

S437GB

Round Shower Knob
Brushed Graphite

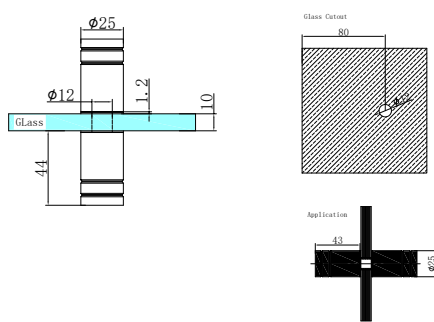

S433GB

Over-Panel Glass to Glass Fitting 10mm Glass
Brushed Graphite

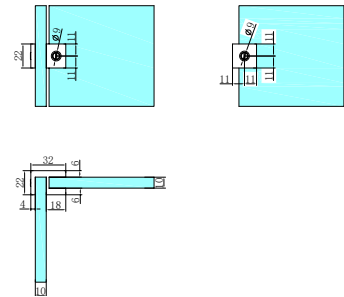

S434GB

Shower F Bracket 10mm Glass
Brushed Graphite

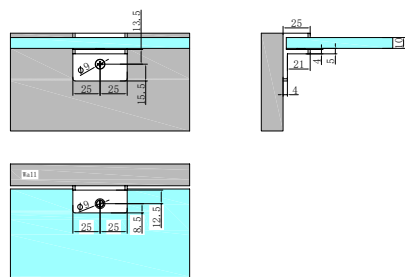

S435GB

Shower U Bracket 10mm Glass
Brushed Graphite

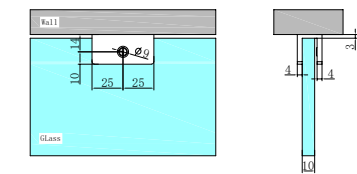

S441GB

Square Shower Knob Handle
Brushed Graphite

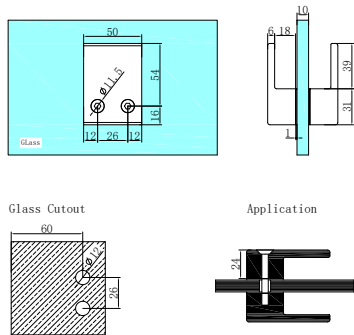

S442GB

Towel Bar 500mm
Brushed Graphite

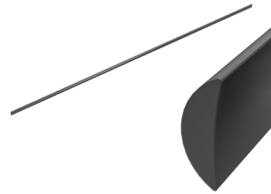
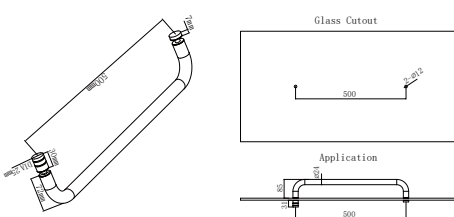

S438GB

Half Round Water Seal Rail 750mm
Brushed Graphite

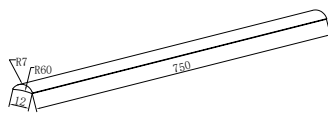

Warranty Periods

1. Goods sold by are made to the highest industry standards and quality, which is reflected in the warranty against defects.

2. This warranty policy is issued by Feramolli Rubinetterie Srl Via L. Abbiati, 48 - 25131 - Brescia (BS) Italy, telephone: +39 800 940 525, email: global@feramolli.com.

3. The following warranty periods apply to goods purchased after 1 January 2024:

Category	Warranty Period	Warranty Details
Mixer Taps	10 years	<ul style="list-style-type: none">· 10 years Replacement Cartridge only.· 10 years Replacement products or parts on all finishes.· 1 year Replacement products or parts & Labour.
Showers	10 years	<ul style="list-style-type: none">· 10 years Replacement products or parts on chrome finishes. Note: Metal Shower hoses only have 5 years replacement warranty.· 10 years Replacement products or parts on other finishes.· 1 year replacement products or parts & Labour.
Bath Outlets	10 years	<ul style="list-style-type: none">· 10 years replacement products or parts only on all finish.
Bathroom Accessories	10 years	<ul style="list-style-type: none">· 10 years Replacement products or parts only.
Other Accessories	10 years	<ul style="list-style-type: none">· 10 years on universal pop up waste replacement only.· 10 years on bottle trap replacement only.· 10 years on glass hardware replacement only.· 10 years on floor waste replacement only.
Commercial Range	1 year	<ul style="list-style-type: none">· 1 year Replacement products or parts & Labour.

4. The warranty period commences from date of purchase, or for new buildings from date of handover.

5. To make a warranty claim, the customer must either contact the seller from which the customer purchased the goods, or contact the Supplier directly by telephone on +39 800 940 525, by email at global@feramolli.com. The claimant must provide proof of purchase or equivalent documentation such as handover documentation for new homes.

6. The expense of claiming on the warranty will be borne by the customer claiming on the warranty.

7. This warranty covers the repair or, at Supplier's option, replacement of any goods which are defective through faulty manufacture or materials, free of charge and labour. The Supplier reserves the right to alter, or amend this warranty offer in writing at any time. The Supplier reserves the right to provide minor components (eg. Handles, aerators, buttons, dress rings, spindle/cartridges and seals) as 'Parts Only' to the customer. This warranty does not cover any claims for labour, additional products or parts associated with allegedly faulty goods for work not approved in advance in writing by the Supplier.

8. For installed goods, the Supplier requires adequate access to assess the goods, fittings and fixtures to assess any warranty claim, and to undertake any warranty repairs. The Supplier will not be responsible for any consequential damage or costs where adequate access to goods, fittings or fixtures is not provided.

9. For discontinued or unavailable goods, the Supplier may replace the goods with equivalent current or available goods, using best endeavours to match the appearance and specifications of the original goods.

10. Supplier's obligations under warranty are limited to the repair or, at Supplier's option, replacement of any products of any products which are defective through faulty workmanship or materials. To the extent permitted by law, Supplier will not be liable for any loss to furniture, floor coverings, walls, fixtures or any consequential loss of any kind caused by any defect in the product components.

11. This warranty does not cover defects caused by or arising from any of the following:

11.1.goods installed by a person other than a licenced lumber. This does not apply to bathroom accessories such as towel rails,shelves, etc;

11.2.goods not installed to relevant national standards or state regulations;

1.1.3.tapware exposed to water pressures and/or temperatures that exceed stated limitations as per the standard installation instructions. Specifies 500kPa maximum water supply pressure at any outlet within a building for new installations;

11.4.fitting of other devices to the outlet of tapware (eg water filters);

1.5.fitting of in tap body or end of line water flow regulating devices that have not been approved by Supplier;

1.6.damage as a result of obstruction due to inadequate flushing of system before use,

1.1.7. service, repairs or other non-standard replacement parts previously undertaken without Supplier's prior written approval;

11.8.damage to finishes by adhesives, sealant, etc;

11.9.damage to finishes which arise from installation or post-installation use;

1.10.failure to observe manufacturer's care and cleaning instructions;

1.11.improper or abusive use of product and/or damage resulting from misuse, accident or neglect.

12. Should any warranty claim be made and service attended to by the Supplier or its authorised service agent, and the fault is due to a cause expressly excluded from this warranty above, the Supplier reserves the right to charge a service fee for attending and/or any work carried out.

13. This warranty is in addition to customer's rights under the Australian Consumer Law.

14. Our goods and services come with guarantees that cannot be excluded under the Australian Consumer Law. For major failures with the service, you are entitled:

14.1.to cancel your service contract with us; and

14.2 to refund for the unused portion, or to compensation for its reduced value. You are also entitled to choose a refund or replacement for major failures with goods. If a failure with the goods or a service does not amount to a major failure, you are entitled to have the failure rectified in a reasonable time. If this is not done you are entitled to a refund for the goods and to cancel the contract for the service and obtain a refund of any unused portion. You are also entitled to be compensated for any other reasonably foreseeable loss or damage from a failure in the goods or service.

Notes

This image shows a blank sheet of white paper with horizontal ruling lines. The lines are evenly spaced and run across the width of the page. There are no margins, text, or other markings on the paper.